



red dot design award
winner 2012

FF-MED- MEGAPROGRESS

Product overview MEGApgress

functional cabinet series redesign valid from 1.1.2015

Former serial product of Blanco Professional



MEGAPROGRESS – CONTENTS

Contents	
Stainless-steel table tops	4
Stainless-steel table top accessories	5
Welded-in basin	7
Hospital drain	9
Stainless-steel basin accessories	10
Fittings and mixer taps	12
Fitting and mixer tap accessories	14
Table top accessories – general	15
Base cabinet as per DIN standard	17
Base cabinet – refrigeration unit	32
Base cabinet with warming device	33
Warming drawer	34
Base cabinet for drain	35
Base cabinet for ultrasound unit	36
Gynaecology cabinet	39
Plaster bench system and accessories	39
High cabinet as per DIN standard	42
Implant cabinet	50
Endoscopy cabinet	52
Catheter cabinet	57
Drug cabinet	59
Practice cabinet	61
High cabinet for refrigeration units	62
Combination cabinet	70
Warming drawer	71
Wall cabinet as per DIN standard	72
Top-mounted cabinet as per DIN standard	77
ISO module base cabinet	78
ISO module high cabinet	81
ISO module wall cabinet	84
ISO module top-mounted cabinet	86
Module equipment	87
STU high cabinet	88
Pass-through compartment system	94
STU accessories	96
Plinth	98
Cabinet shelf	99
Shelf	103
Light panels and accessories	104
LED light panels and accessories	106
Electronic lock and accessories	107
FF-click, accessories and partition wall	108
Narcotics safe	109
Accessories	111
Refrigeration units	115
Panels as per DIN and ISO standard, powder-coated	118
Panels as per DIN and ISO standard, stainless steel	119
Ladders for cabinets as per DIN and ISO standard	120
Panels as per DIN and ISO standard	121
Wall shelf	122

FF Co. Ltd.
 Budapest - HQ Office
 H-1101 Budapest, Kőbányai út 49.
 Tel.: +36 1 4342 995
 Fax: +36 1 4342 994
 Mezőtúr - Factory
 H-5400 Mezőtúr, Vásárhelyi Pál u. 2.
 Tel.: +36 56 578 400
 Fax: +36 56 578 401
 sales@ffzrt.hu
 www.ffzrt.hu

MEGAPROGRESS **STAINLESS-STEEL TABLE TOPS**



Table top

Model MTP

Smooth worktop made of 1.25 mm stainless steel, AISI 304, ground 320 grain and brushed to satin finish, turned down 40 mm on all sides.

The underside is fitted with V 20 particle board for noise insulation and also reinforced with an all-round frame. Panelled with stainless steel at front.

Max. length of a table top 3,850 mm continuous, extendable with screw joint.

Stainless steel

Art. No.	Depth mm	Thickness mm
MC0001	up to 650	40
MC0003	up to 850	40

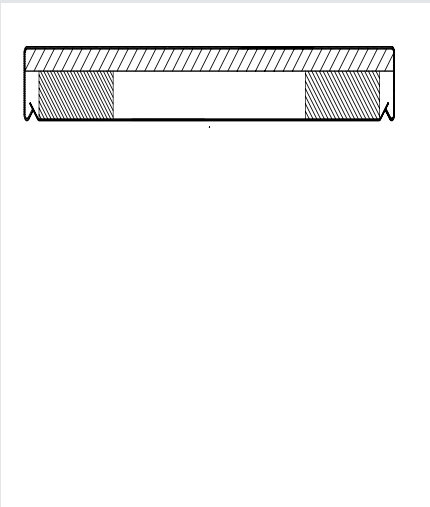

Table top

Model MTPB

Smooth worktop made of 1.25 mm stainless steel, AISI 304, ground in 320 grain and brushed to satin finish, turned down 40 mm on all sides.

The underside is fitted with V 20 particle board for noise insulation and also reinforced with an all-round frame. Underside smooth panelled with stainless-steel sheet over entire surface.

Max. length of a table top 3,850 mm continuous, extendable with screw joint.

Stainless steel

Art. No.	Depth mm	Thickness mm
MC0005	up to 650	40
MC0007	up to 850	40

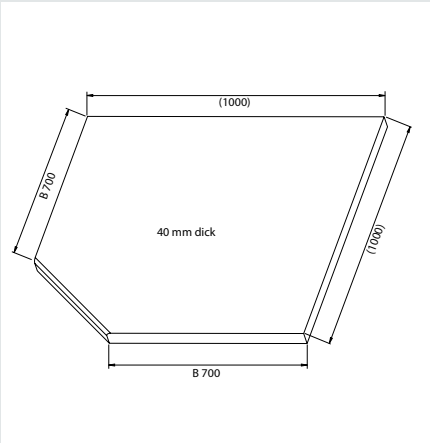

Corner table top

without screw joint, without vertical shelf

Stainless steel

Art. No.	Width mm	Depth mm	Description
MC0145	1000	1000	Model MTP, with depth of 700 mm
MC0146	1000	1000	Model MTPB, with depth of 700 mm

MEGAPROGRESS STAINLESS-STEEL TABLE TOP ACCESSORIES

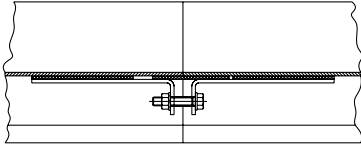

Screw joint

for stainless-steel table tops

Art. No.

580130

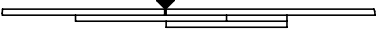

Welded joint

for stainless-steel table tops

Art. No.

MC0400

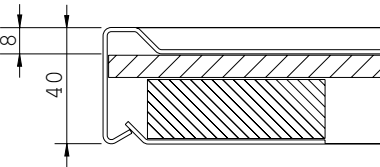

Profile edge for MTP/MTPB model for stainless-steel table tops

Stainless steel

Art. No.	Height mm
MC0028	8

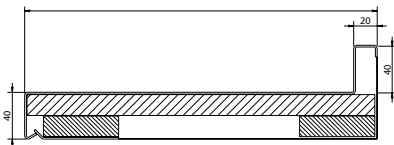

Vertical shelf Z 40/20

Stainless steel

Art. No.	Description
MC0030	at rear
MC0031	2-sided
MC0032	3-sided

Vert. shelf Z 40/20

front shortened,
one-sided

Stainless steel

Art. No.

MC0099

Vert. shelf Z 150/20

one-sided

Stainless steel

Art. No.

MC0098

MEGAPROGRESS STAINLESS-STEEL TABLE TOP ACCESSORIES

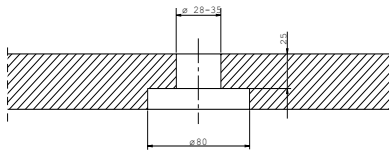

Fitting hole

for 28–35 mm dia.

Art. No.	Diameter mm
MC0029	28–35

Table top hole

with stainless-steel panelling (MTP) and sleeve

Art. No.

MC0103

Table top cut-out

Art. No.	Description
MC0100	L-shaped pillars mounted on wall
MC0101	L-shaped pillars mounted on front
MC0102	U-shaped pillars mounted on wall

Stamped grooved surface

Stainless steel

Art. No.	Width mm	Depth mm	Description
MC0033	600	400	without incline
MC0034	600	400	with incline

Cut-out for with mount for ultrasound basin

Art. No.

MC0036

Ventilation grate for stainless-steel table top

punched in

Stainless steel

Art. No.

538331

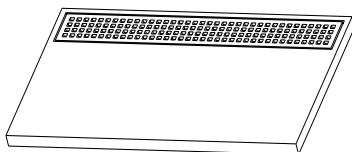

MEGAPROGRESS **WELDED-IN BASIN**

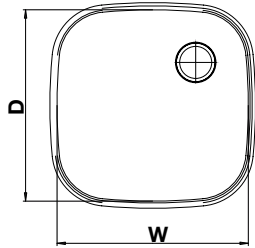

Welded-in basin (only in conjunction with stainless-steel table tops)

Stainless-steel basin

Stainless steel				
Art. No.	Width mm	Depth mm	Height mm	Description
200855	240	340	150	Drain in centre, 1 ½"
203400	240	370	150	Drain in centre, 1 ½"
MC0090	370	340	150	Drain at rear right or left, 1 ½"
MC0401	400	400	200	Drain at rear right or left (reversible), 1 ½"
MC0083	400	400	250	Drain at rear right or left, 1 ½"
MC0084	400	400	300	Drain at rear right or left, 1 ½"
MC0142	500	400	250	Drain at rear right or left, 1 ½"
MC0086	500	400	300	Drain at rear right or left, 1 ½"
MC0087	500	500	250	Drain at rear right or left, 1 ½"
MC0088	500	500	300	Drain at rear right or left, 1 ½"
MC0089	500	500	350	Drain at rear right or left, 1 ½"
602253	600	400	250	hand-welded Drain at rear right, 1 ½"
602254	600	400	250	hand-welded Drain at rear left, 1 ½"
MC0250	600	450	250	Drain on right or left, 1 ½"
MC0143	600	450	300	Drain on right or left, 1 ½"
MC0091	600	500	250	Drain at rear right or left, 1 ½"
MC0092	600	500	300	Drain at rear right or left, 1 ½"
MC0093	600	600	300	Drain at rear right or left, 1 ½"
MC0094	700	600	300	Drain at rear right or left, 1 ½"
Other dimensions on request				

Note:

When installing the welded-in basins in MTBP stainless-steel table tops plus basin cut-out and sealing.

MEGAPROGRESS **WELDED-IN BASIN**

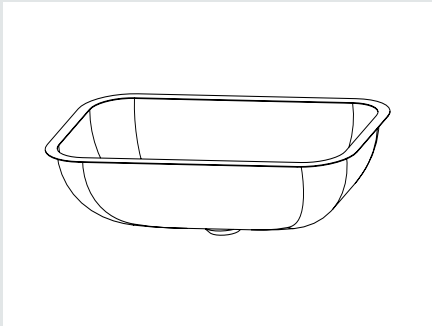

Hand-washing basin

Drain in centre, 1 ½"

Stainless steel

Art. No.	Width mm	Depth mm	Height mm
MC0096	500	300	150

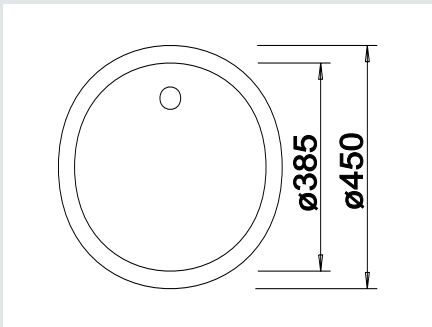

Welded-in basin, round

without overflow, drain at centre rear, 1 ½", basin size dia. 385 x 165 mm

Stainless steel

Art. No.	Width mm	Depth mm	Height mm
511407	450	450	165

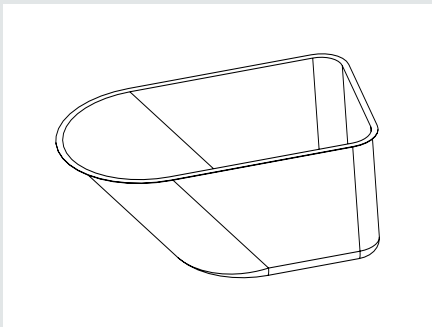

Welded-in infant bathtub

Drain at rear right, 1 ½"

Stainless steel

Art. No.	Width mm	Depth mm	Height mm
233746	720	420	300

Note: When installing the welded-in basins in MTBP stainless-steel table tops plus basin cut-out and sealing.

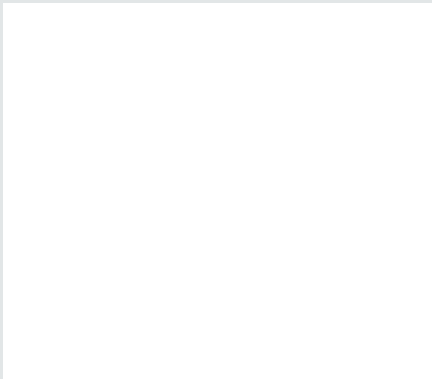

Top surface for welded-in basin

adjusted to basin size

Stainless steel

Art. No.	Description
54958001	with handles, double-walled with rubber seal
54958002	with grip hole

MEGAPROGRESS HOSPITAL DRAIN

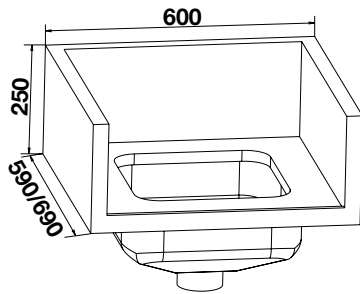

Hospital drain

Table top made of stainless steel with profile edge at front and welded-in utility sink 400 x 400 x 200 mm, drain opening with edge rinsing, 345 x 345 mm, including 3-sided splash wall, with side panelling, incl. swingaway support rack, with edge rinsing

Stainless steel

Art. No.	Width mm	Depth mm	Height mm	Description
542545	600	590	250	Model MAB 6 x 6 NW 70, with edge rinsing
542515	600	590	250	Model MAB 6 x 6 NW 100, with edge rinsing
542546	600	690	250	Model MAB 6 x 7 NW 70, with edge rinsing
542516	600	690	250	Model MAB 6 x 7 NW 100, with edge rinsing

Forming drain on top surface

Art. No.

MC0040

Odour trap for hospital drain

Model MAB 6 x 6 and Model MAB 6 x 7, adjustable, NW 70

Art. No.

137830

Odour trap for hospital drain

Model MAB 6 x 6 and Model MAB 6 x 7, fixed, NW 100

Art. No.

232044

Tank/pump system for hospital drain, Model ATT

Model "N", in accordance with DIN 1988, normal program with approx. 6 ltr. rinsing volume

Art. No.

245673

MEGAPROGRESS **STAINLESS-STEEL BASIN ACCESSORIES**



1 1/2" eccentric drain set

Synthetic

Art. No.	Description
137195	with Bowden cable and pull knob, chrome-plated, without overflow



1 1/2" tube overflow with rubber taper

Stainless steel

Art. No.	Description
369961	with rubber taper, stainless-steel basket strainer, without brazed union for basin depth 150 mm, water column 130 mm
369962	with rubber taper, stainless-steel basket strainer, without brazed union for basin depth 200 mm, water column 180 mm
369963	with rubber taper, stainless-steel basket strainer, without brazed union for basin depth 250 mm, water column 200 mm
369964	for drain with rubber taper, stainless-steel basket strainer, without brazed union for basin depth 300 mm, water column 250 mm



1 1/2" tube overflow with brass taper

Stainless steel

Art. No.	Description
340583	heavy model, with brass taper and basket strainer for basin depth 150 mm, water column 130 mm
340584	heavy model, with brass taper and basket strainer for basin depth 200 mm, water column 180 mm
340585	heavy model, with brass taper and basket strainer for basin depth 250 mm, water column 200 mm
369965	heavy model, with brass taper and basket strainer for basin depth 300 mm, water column 250 mm

MEGAPROGRESS **STAINLESS-STEEL BASIN ACCESSORIES**



Odour trap

Synthetic

Art. No.	Description
137267	Siphon, 1½" synthetic pipe odour trap with adjustable drain, 50 mm dia. outlet

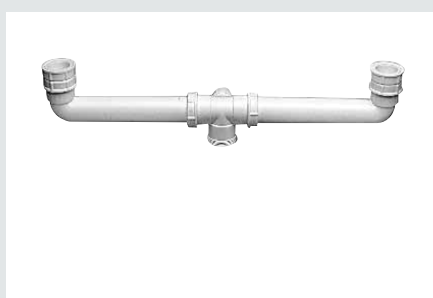

Accessories for stainless-steel basins

Synthetic

Art. No.	Description
369969	1½" synthetic drain connection for double basin units

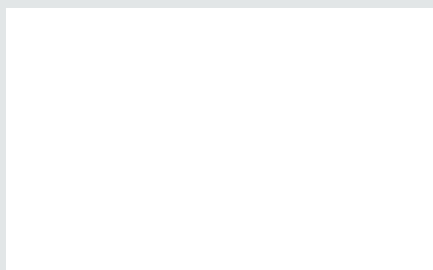

Collar cover

Synthetic

Art. No.	Description
137832	Synthetic collar cover, white, NW 50, for use with 137267

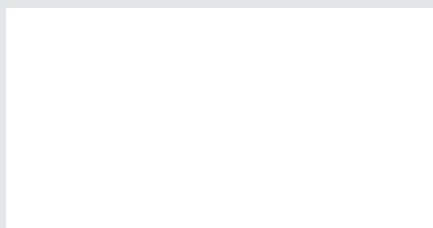

Cover plate for drain trap

Art. No.	Description
602154	2-piece with hole for odour trap for cut-out in cabinet rear wall

MEGAPROGRESS FITTINGS AND MIXER TAPS

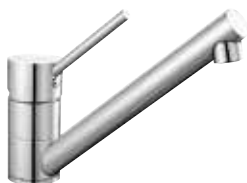

BLANCO ANTAS

Chrome, drain can be swivelled 360°, hole for tap with 0.35 mm required, cartridge with ceramic disk technology, flexible connection tubes of 450 mm in length with 3/4" nut for especially easy and secure assembly, patented stream controller for significantly reduced calcification, ND model with flow regulator to protect the boiler, stabilising plate for increased fitting stability for assembly in stainless-steel basins, LGA certified*, DVGW certified* (*for high-pressure model).

High-pressure

Art. No.

515337

Low-pressure

Art. No.

516103



BLANCO ANTAS-S

Chrome, drain can be swivelled 140°, hole for tap with 0.35 mm required, cartridge with ceramic disk technology, shower hose with metal casing, flexible connection tubes of 450 mm in length with 3/4" nut for especially easy and secure assembly, patented stream controller for significantly reduced calcification, ND model with flow regulator to protect the boiler, stabilising plate for increased fitting stability for assembly in stainless-steel basins, equipped with non-return valve as standard to prevent backflow in acc. with EN 1717, LGA certified*, DVGW certified* (*for high-pressure model).

High-pressure

Art. No.

515348

Low-pressure

Art. No.

516764



BLANCO ELIPSO II single-lever mixer tap

Chrome, high-pressure, drain can be swivelled 130° hole for tap with 35 mm dia. required, cartridge with ceramic disk technology, flexible connection tubes of 450 mm in length and 3/8" nut, patented stream controller for significantly reduced calcification, stabilising plate for increased fitting stability for assembly in stainless-steel basins, LGA certified, DVGW certified.

Art. No.

514879



BLANCO ELIPSO-S II single-lever mixer tap

Chrome, drain can be swivelled 115°, pull-out hand shower with 2 shower modes, hole for tap with 0.35 mm required, cartridge with ceramic disk technology, shower hose with metal casing, flexible connection tubes of 450 mm in length with 3/8" nut, patented stream controller for significantly reduced calcification, stabilising plate for increased fitting stability for assembly in stainless-steel basins, equipped with non-return valve as standard to prevent backflow in acc. with EN 1717, LGA certified, DVGW certified.

Art. No.

514847

MEGAPROGRESS FITTINGS AND MIXER TAPS



Medi-care single-lever mixer tap

DN 8 chrome-plated, clinic single-hole tap, drain can be swivelled, projection 200 mm, with clinic arm lever

Art. No.

543130

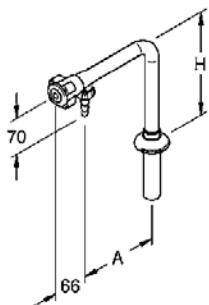

Vertical fitting for free-standing demineralised water column

Laboratory vertical column for demineralised water

with corner valve, control handle coloured in accordance with DIN 12920 (E DIN EN 13792), fitting EPS-coated, grey (RAL 7001), chemically nickel-plated inside, screw hose fitting flat-sealing with hose nozzle (10/13 mm diameter) and stream controller in accordance with DIN 12898, Perbunan sealing disc and washer with counter-nut. G 3/4 B connection thread, 100 mm long. Maximum pressure at rest 10 bar. Maximum operating temperature 70° C.

Art. No.	Height mm
----------	--------------

542998	200
---------------	-----



1/2" two-hole mixer tap

Wall tap
Spray wash arm for wall tap

Art. No.

137380

Extension for wall mounting by an additional 60 mm

for two-hole mixer tap

Art. No.

127579



1/2" two-hole mixer tap

Vertical fitting
with swivel faucet, can be switched over to hand shower, with automatically closing valve KWC, shower projection 400 mm, tube riser wall distance 60 mm, table height to UK shower head 270 mm, total height 1060 mm, hole spacing 153 mm, 22 mm dia. hole

Stainless steel

Art. No.	Height mm
----------	--------------

137379	1060
---------------	------

MEGAPROGRESS FITTING AND MIXER TAP ACCESSORIES



1½" cleaning nozzle
with 8 attachments ¾" and 1.5 m metal hose, including table collar

Art. No.
145310

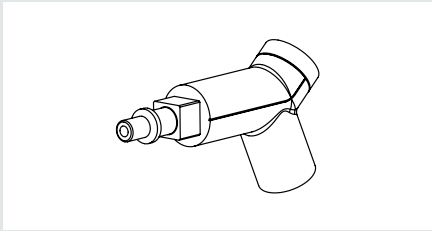

Compressed-air elbow connector for cleaning gun

Art. No.
600060

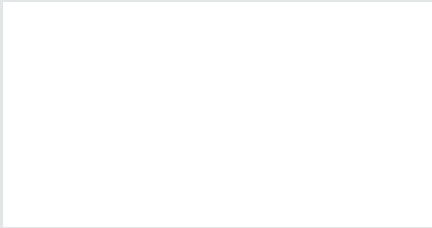

Table collar for additional cleaning nozzle
without hose taper, 35 mm dia. hole

Art. No.
145311



Shutoff valve
¾" shutoff valve
35 mm dia. hole

Art. No.
530090

MEGAPROGRESS TABLE TOP ACCESSORIES – GENERAL



Vertical splash guard made of Plexiglas

with or without cut-out for vertical shelf, each incl. 3 x open bracket and 1 x closed bracket for front, size up to max. W = 665 mm, H = 490 mm

Art. No.	Description	Width mm	Depth mm	Height mm
543037	Vertical splash guard made of Plexiglas with or without cut-out for vertical shelf, incl. 3 x open holders, 1 x closed holder			
54309101	Vertical splash guard made of laminated safety glass for base cabinet, incl. 2x solid holders made of stainless steel	6	400	510
54309102	Vertical splash guard made of laminated safety glass for base cabinet, incl. 2x solid holders made of stainless steel	6	500	510
54309103	Vertical splash guard made of laminated safety glass for below wall cabinet, with cut-out for Thebo lamp, incl. 3x solid holders made of stainless steel	6	400	510
54309104	Vertical splash guard made of laminated safety glass for below wall cabinet, with cut-out for Thebo lamp, incl. 3x solid holders made of stainless steel	6	500	510
54309105	Vertical splash guard made of laminated safety glass for below wall cabinet, with cut-out for Thebo lamp, incl. 3x solid holders made of stainless steel	6	500	400
54309106	Vertical splash guard made of laminated safety glass for below wall cabinet without lamp, incl. 3x solid holders made of stainless steel	6	400	510
54309107	Vertical splash guard made of laminated safety glass for below wall cabinet without lamp, incl. 3x solid holders made of stainless steel	6	500	510
54309108	Vertical splash guard made of laminated safety glass for below wall cabinet without lamp, incl. 3x solid holders made of stainless steel	6	500	400

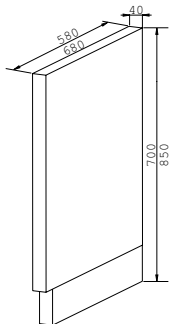

Support wall

Stainless steel			Powder-coated
Art. No.	Depth mm	Description	Art. No.
53059001	580	for 740 mm working height	54059001
53059003	580	for 890 mm working height	54059003
53059002	680	for 740 mm working height	54069002
53059004	680	for 890 mm working height	54059004

MEGAPROGRESS **TABLE TOP ACCESSORIES – GENERAL**

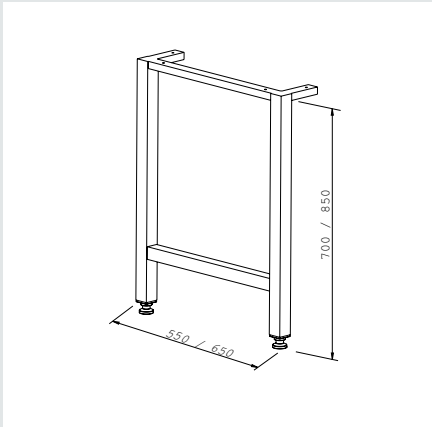

Support foot

Stainless steel

Art. No.	Depth mm	Description
54983601	550	for 740 mm working height, made of 40 mm tube
54983603	650	for 740 mm working height, made of 40 mm tube
54983602	550	for 890 mm working height, made of 40 mm tube
54983604	650	for 890 mm working height, made of 40 mm tube

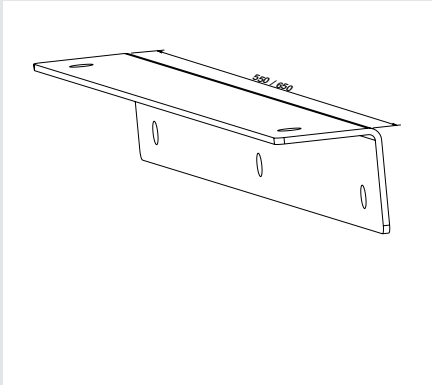

Mounting angle

Stainless steel

Art. No.	Depth mm
536991	450
531284	550
531285	650

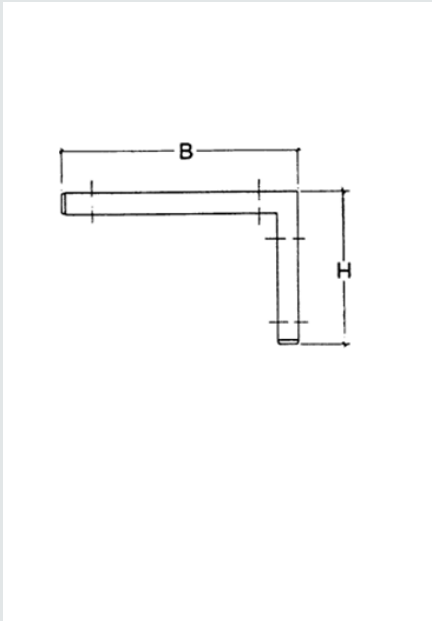

Bracket

Model KO

Bracket in stainless-steel tube, variable height

Stainless steel

Art. No.	Width mm	Description
54298001	475	in 25 mm tube
54298004	475	in 40 mm tube
54298002	575	in 25 mm tube
54298005	575	in 40 mm tube
54298003	675	in 25 mm tube
54298006	675	in 40 mm tube

MEGAPROGRESS BASE CABINET AS PER DIN STANDARD

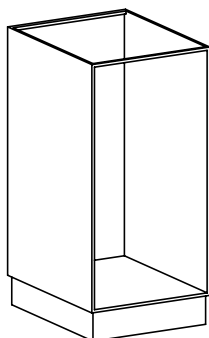

Base cabinet, open

Model MOB

Optional shelf

Powder-coated				Stainless steel
Art. No.	Width mm	Depth mm	Height mm	Art. No.
53764001	450	557	700	54764001
53764002	600	557	700	54764002
53764003	900	557	700	54764003
53764004	1200	557	700	54764004
53764005	450	557	850	54764005
53764006	600	557	850	54764006
53764007	900	557	850	54764007
53764008	1200	557	850	54764008

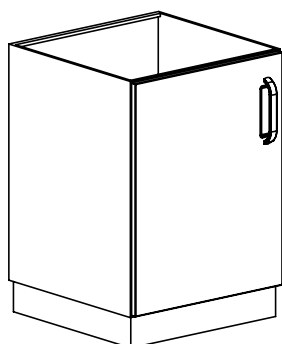

Base cabinet with hinged door

Model MFB1

1 hinged door, left or right-hand hinging
1 handle

Powder-coated				Stainless steel
Art. No.	Width mm	Depth mm	Height mm	Art. No.
53764101	450	580	700	54764101
53764105	600	580	700	54764105
53764109	450	580	850	54764109
53764113	600	580	850	54764113

MEGAPROGRESS BASE CABINET AS PER DIN STANDARD

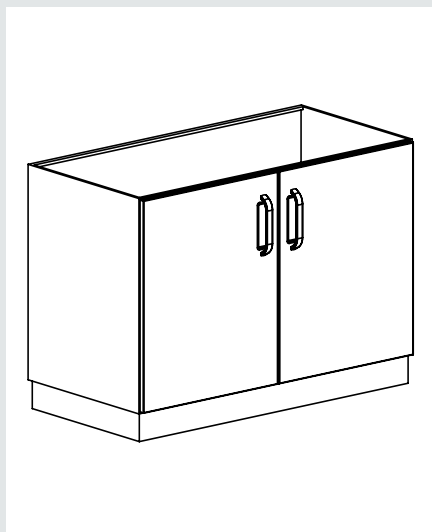

Base cabinet with hinged door

Model MFB2

2 hinged doors
2 handles

Powder-coated				Stainless steel
Art. No.	Width mm	Depth mm	Height mm	Art. No.
53764201	900	580	700	54764201
53764203	1200	580	700	54764203
53764205	900	580	850	54764205
53764207	1200	580	850	54764207

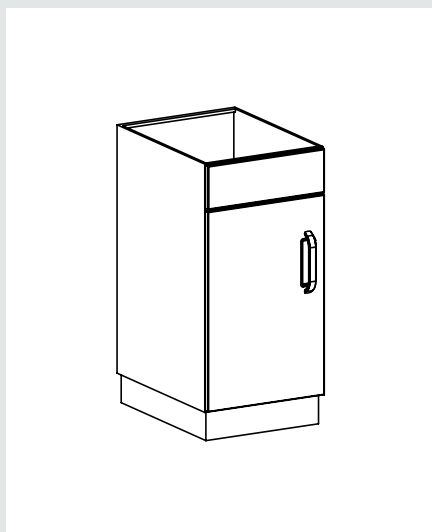

Base cabinet with door and panel

Model MFBB1

1 hinged door, left or right-hand hinging
1 handle
1 basin trim panel, 150 mm high

Powder-coated				Stainless steel
Art. No.	Width mm	Depth mm	Height mm	Art. No.
53764301	450	580	850	54764301
53764305	600	580	850	54764305

MEGAPROGRESS BASE CABINET AS PER DIN STANDARD

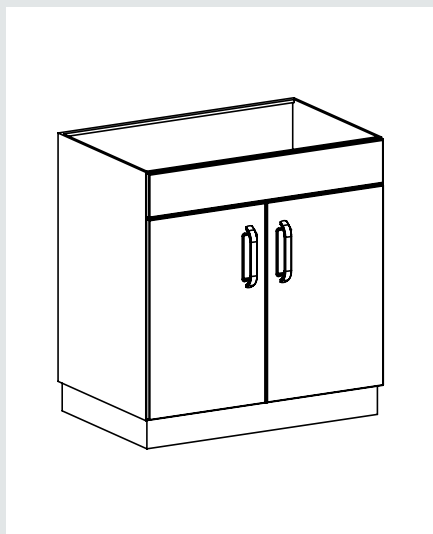

Base cabinet with hinged doors and panel

Model MFBB2

2 hinged doors
2 handles
1 basin trim panel, 150 mm high

Powder-coated				Stainless steel
Art. No.	Width mm	Depth mm	Height mm	Art. No.
53764401	900	580	850	54764401
53764403	1200	580	850	54764403

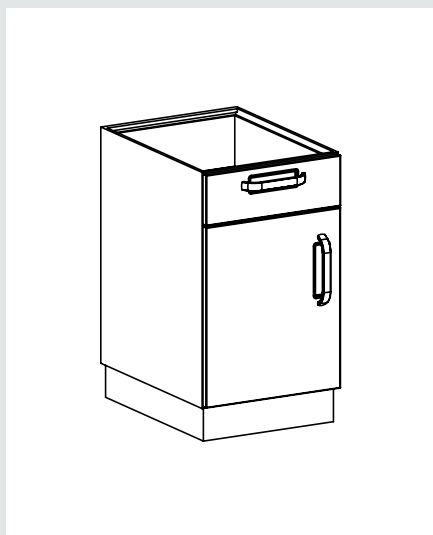

Base cabinet with door and drawer

Model MFBS1

1 hinged door, left or right-hand hinging
2 handles
1 drawer, 150 mm high

Powder-coated				Stainless steel
Art. No.	Width mm	Depth mm	Height mm	Art. No.
53764501	450	580	700	54764501
53764505	600	580	700	54764505
53764509	450	580	850	54764509
53764513	600	580	850	54764513

MEGAPROGRESS BASE CABINET AS PER DIN STANDARD

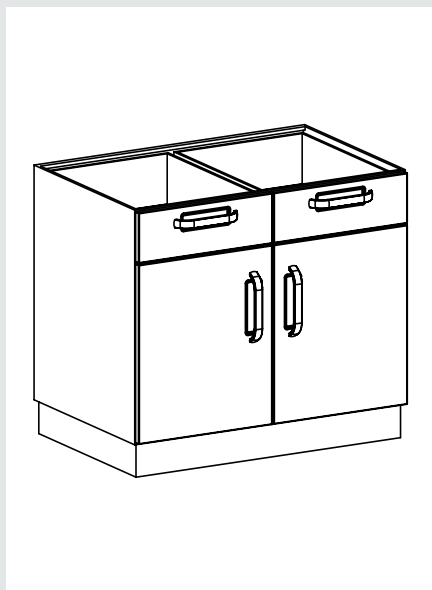

Base cabinet with hinged doors and drawers

Model MFBS2

2 hinged doors
4 handles
2 drawers, 150 mm high

Powder-coated				Stainless steel
Art. No.	Width mm	Depth mm	Height mm	Art. No.
53764601	900	580	700	54764601
53764603	1200	580	700	54764603
53764605	900	580	850	54764605
53764607	1200	580	850	54764607

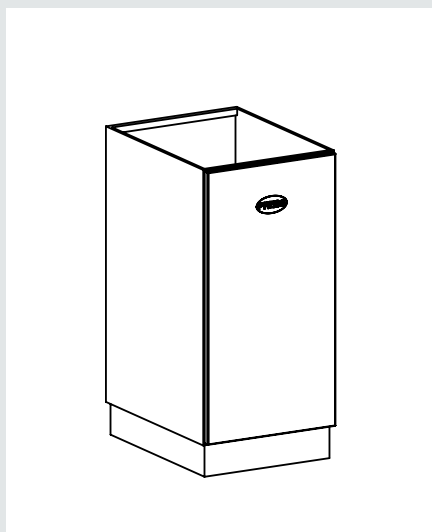

Base cabinet with tilt drawer

Model MKB

1 tilt drawer with pneumatic door brake,
inside of door with fold-up hanging bars and shelf for synthetic garbage bags (60 ltr.),
cannot be mounted below basin

Powder-coated				Stainless steel
Art. No.	Width mm	Depth mm	Height mm	Art. No.
53764701	450	580	850	54764701
53764702	600	580	850	54764702

MEGAPROGRESS BASE CABINET AS PER DIN STANDARD

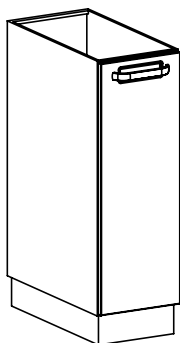

Base cabinet with pull-out

Model MLTA

1 pull-out with 1 stainless-steel collection container
1 handle

Powder-coated					St. steel
Art. No.	Width mm	Depth mm	Height mm	Description	Art. No.
53764801	300	580	850	Dimensions of stainless-steel collection container: 195 x 425 x 550 mm or: 195 x 425 x 450 mm	54764801
53764802	450	580	850	Dimensions of stainless-steel collection container: 345 x 425 x 550 mm or: 345 x 425 x 450 mm	54764802

MEGAPROGRESS BASE CABINET AS PER DIN STANDARD

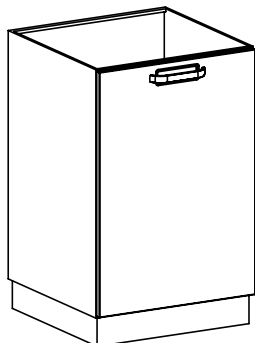

Base cabinet with waste separation system

Model MLTAS

1 manual extension
1 handle
integrated waste separation system
with 3 synthetic buckets (1 x 18.5 ltr.; 2 x 16 ltr.)

Powder-coated				Stainless steel
Art. No.	Width mm	Depth mm	Height mm	Art. No.
53763301	600	580	850	54763301

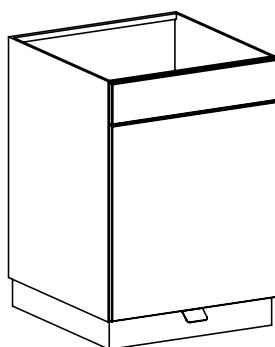

Base cabinet with waste separation system

Model MLTASK

1 pull-out with foot operation
1 basin trim panel, 150 mm high

Powder-coated					St. steel
Art. No.	Width mm	Depth mm	Height mm	Description	Art. No.
54200302	450	580	850	integrated waste separation system with 2 buckets (2 x 18.0 ltr.)	54200402
54200303	450	580	850	integrated waste separation system with 3 buckets (1 x 18.0 ltr.; 2 x 8 ltr.)	54200403
54200301	600	580	850	integrated waste separation system with 3 buckets (1 x 18.5 ltr.; 2 x 16 ltr.)	54200401

MEGAPROGRESS BASE CABINET AS PER DIN STANDARD

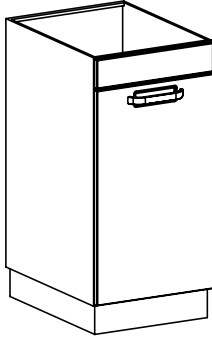

Base cabinet with waste separation system and basin trim panel

Model MLTASB

1 manual extension
1 basin trim panel
1 handle

Powder-coated					St. steel
Art. No.	Width mm	Depth mm	Height mm	Description	Art. No.
53790202	450	580	850	integrated waste separation system with 3 buckets (1 x 18.5 ltr.; 2 x 8 ltr.)	54243302
53790201	600	580	850	integrated waste separation system with 3 buckets (1 x 18.5 ltr.; 2 x 8 ltr.)	54243301

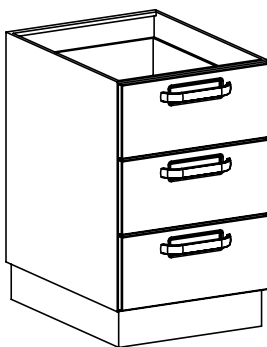

Base cabinet with drawers

Model MLT/3

3 drawers, 200 mm high each
3 handles

Powder-coated				Stainless steel
Art. No.	Width mm	Depth mm	Height mm	Art. No.
53765001	450	580	700	54765001
53765003	600	580	700	54765003
53765002	900	580	700	54765002
53765004	1200	580	700	54765004

MEGAPROGRESS BASE CABINET AS PER DIN STANDARD

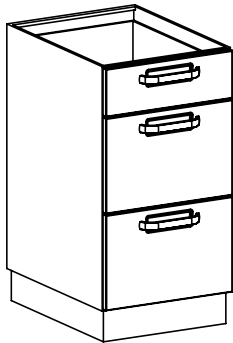

Base cabinet with drawers

Model MLT/3

2 drawers, 300 mm high each
1 drawer, 150 mm high
3 handles

Powder-coated				Stainless steel
Art. No.	Width mm	Depth mm	Height mm	Art. No.
53765005	450	580	850	54765005
53765007	600	580	850	54765007
53765006	900	580	850	54765005
53765008	1200	580	850	54765007

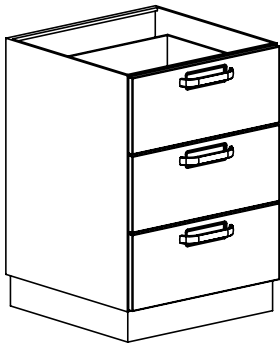

Base cabinet with drawers

Model MLT/3

3 drawers, 250 mm high each
3 handles

Powder-coated				Stainless steel
Art. No.	Width mm	Depth mm	Height mm	Art. No.
53765009	450	580	850	54765009
53765011	600	580	850	54765011
53765010	900	580	850	54765010
53765012	1200	580	850	54765012

MEGAPROGRESS BASE CABINET AS PER DIN STANDARD

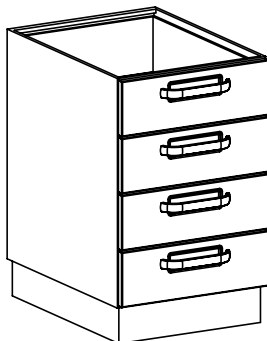

Base cabinet with drawers

Model MLT/4

4 drawers, 150 mm high each
4 handles

Powder-coated				Stainless steel
Art. No.	Width mm	Depth mm	Height mm	Art. No.
53765013	450	580	700	54765013
53765015	600	580	700	54765015
53765014	900	580	700	54765014
53765016	1200	580	700	54765016

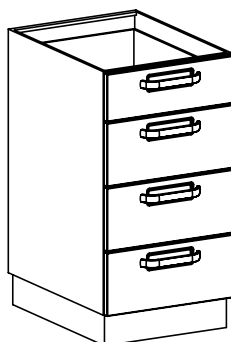

Base cabinet with drawers

Model MLT/4

3 drawers, 200 mm high each
1 drawer, 150 mm high
4 handles

Powder-coated				Stainless steel
Art. No.	Width mm	Depth mm	Height mm	Art. No.
53765017	450	580	850	54765017
53765019	600	580	850	54765019
53765018	900	580	850	54765018
53765020	1200	580	850	54765020

MEGAPROGRESS BASE CABINET AS PER DIN STANDARD

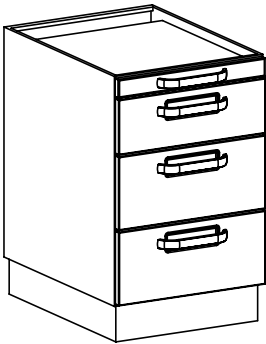

Base cabinet with drawers

Model MLT/4

with pull-out worktop
2 drawers, 200 mm high each
1 drawer, 150 mm high
1 pull-out worktop, 50 mm high

Powder-coated				Stainless steel
Art. No.	Width mm	Depth mm	Height mm	Art. No.
53765021	450	580	700	54765021
53765023	600	580	700	54765023

MEGAPROGRESS BASE CABINET AS PER DIN STANDARD

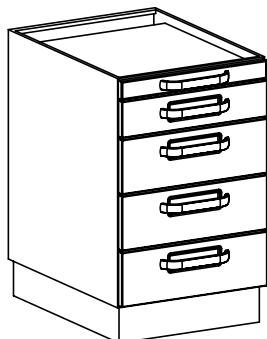

Base cabinet with drawers

Model MLT/5

with pull-out worktop
3 drawers, 150 mm high each
1 drawer, 100 mm high
1 pull-out worktop, 50 mm high

Powder-coated

Art. No.	Width mm	Depth mm	Height mm
53765025	450	580	700
53765027	600	580	700

Stainless steel

Art. No.
54765025
54765027

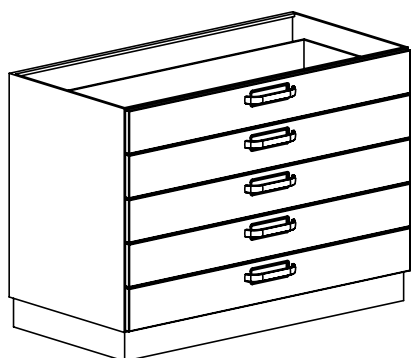

Base cabinet with drawers

Model MLT/5

5 drawers, 150 mm high each
5 handles

Powder-coated

Art. No.	Width mm	Depth mm	Height mm
53765029	450	580	850
53765031	600	580	850
53765033	900	580	850
53765035	1200	580	850

Stainless steel

Art. No.
54765029
54765031
54765033
54765035

MEGAPROGRESS BASE CABINET AS PER DIN STANDARD

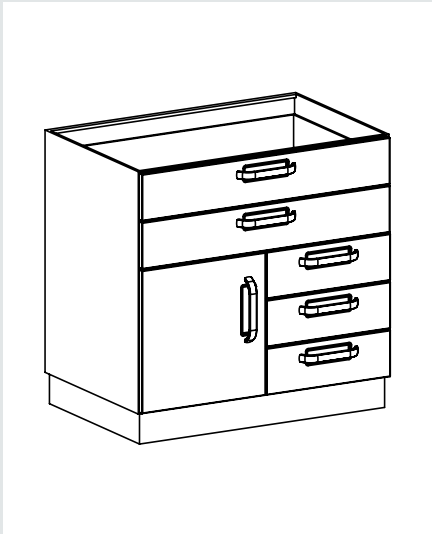

Base cabinet with drawers and door

Model MLTF/5

- 1 door, left-hand hinging
- 3 drawers, 150 mm high, 450 mm wide each
- 2 drawers, 150 mm high, 900 mm wide each
- 6 handles

Powder-coated				Stainless steel
Art. No.	Width mm	Depth mm	Height mm	Art. No.
53765101	900	580	850	54765101

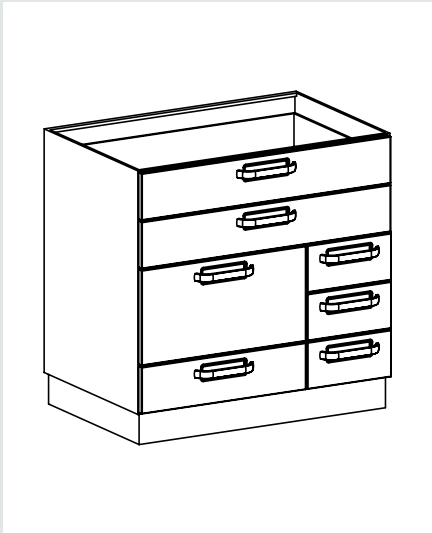

Base cabinet with drawers

Model MLT/7

- 3 drawers, 150 mm high, 300 mm wide each
- 1 drawer, 150 mm high, 600 mm wide
- 1 drawer, 300 mm high, 600 mm wide
- 2 drawers, 150 mm high, 900 mm wide each
- 7 handles

Powder-coated				Stainless steel
Art. No.	Width mm	Depth mm	Height mm	Art. No.
53765201	900	580	850	54765201

MEGAPROGRESS **BASE CABINET AS PER DIN STANDARD**

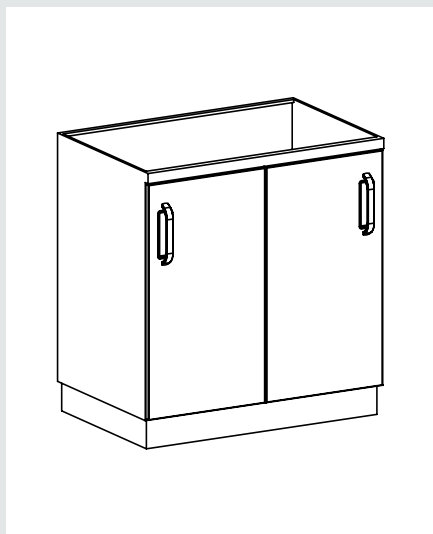

Base cabinet with sliding doors

Model MSB

2 sliding doors
35 mm guide plate
2 handles

Powder-coated				Stainless steel
Art. No.	Width mm	Depth mm	Height mm	Art. No.
53765301	900	580	850	54765301
53765303	1200	580	850	54765303
53765305	1500	580	850	54765305

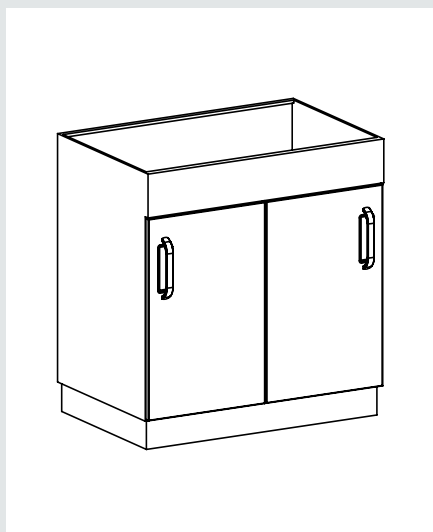

Base cabinet with sliding doors and basin trim panel

Model MSBB

2 sliding doors
2 handles
1 basin trim panel, 150 mm high

Powder-coated				Stainless steel
Art. No.	Width mm	Depth mm	Height mm	Art. No.
53765401	900	580	850	54765401
53765403	1200	580	850	54765403
53765405	1500	580	850	54765405

MEGAPROGRESS BASE CABINET AS PER DIN STANDARD

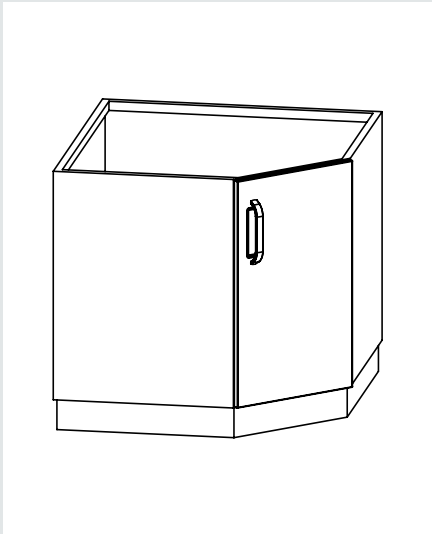

Corner base cabinet

Model MEBE

- 1 hinged door, left or right-hand hinging
- 1 fixed shelf
- 1 handle

Powder-coated				Stainless steel
Art. No.	Width mm	Depth mm	Height mm	Art. No.
53765501	900	580	850	54765501

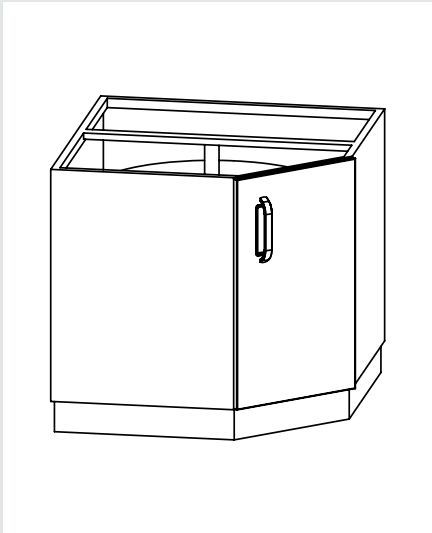

Corner base cabinet

Model MEBD

- 1 hinged door, left or right-hand hinging
- 2 rotating shelves
- 1 handle

Powder-coated				Stainless steel
Art. No.	Width mm	Depth mm	Height mm	Art. No.
53765601	900	580	850	54765601

MEGAPROGRESS BASE CABINET AS PER DIN STANDARD

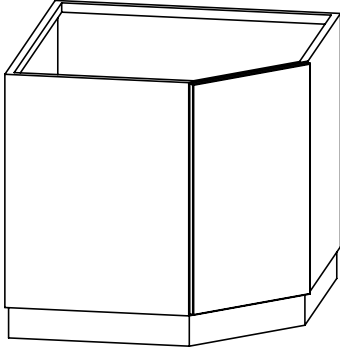

Corner base cabinet

Model MEBK

1 tilt drawer with pneumatic door brake,
inside of door with fold-up hanging bars and shelf for synthetic garbage bags

Powder-coated				Stainless steel
Art. No.	Width mm	Depth mm	Height mm	Art. No.
53762501	900	580	850	54762501

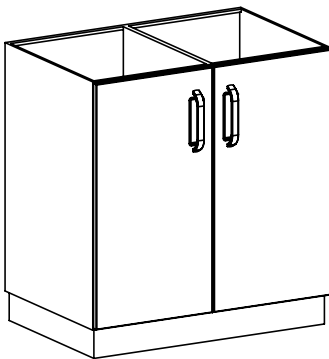

Base cabinet with hinged doors for DIN module

Model EMFB2

2 hinged doors
1 centre partition wall
2 handles
without equipment
for mounting DIN modules, size 535 x 500 mm

Powder-coated				Stainless steel
Art. No.	Width mm	Depth mm	Height mm	Art. No.
53770501	1200	580	700	54770501
53770503	1200	580	850	54770503

MEGAPROGRESS BASE CABINET – REFRIGERATION UNIT

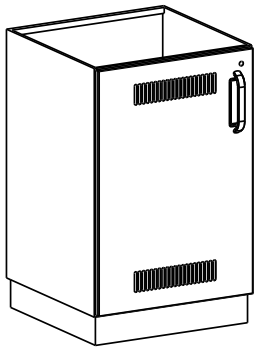

Base cabinet for drug refrigerator

Model MFBK

Price without refrigeration unit
1 front-mounted door, left or right-handed door hinging
lockable with lever lock, ventilation grate
for the integration of a drug refrigerator, Kirsch, Med. 85, 80 ltr.
or Froster Med 70
1 handle

Powder-coated				Stainless steel
Art. No.	Width mm	Depth mm	Height mm	Art. No.
53765701	600	580	850	54765701

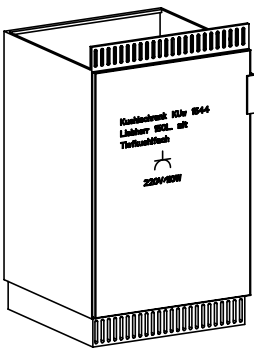

Base cabinet refrigerator

Model MUK

Door hinging on right or left
Base cabinet refrigerator, approx. 150 ltr., adjustable from +2° to + 10° C,
with automatic defroster and -18°C freezer compartment
Liebherr KUw 1544, with decorative trim panel in front colour,
connection 230 V–110 W
(other makes on request)

Powder-coated				Stainless steel
Art. No.	Width mm	Depth mm	Height mm	Art. No.
53765801	600	580	850	54765801

MEGAPROGRESS BASE CABINET WITH WARMING DEVICE

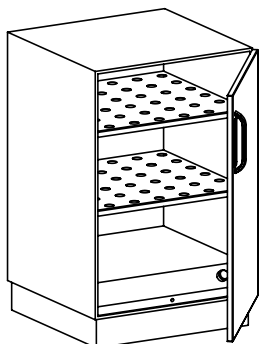

Heating cabinet – base cabinet

Model MFBW1

– NOT SUITABLE FOR STORING INFUSIONS –

1 lockable hinged door, left or right-hand hinging
1 stainless-steel cabinet shelf, perforated
1 handle
Output 1000 W

Powder-coated

Stainless steel

Art. No.	Width mm	Depth mm	Height mm	Art. No.
53765901	600	580	850	54765901

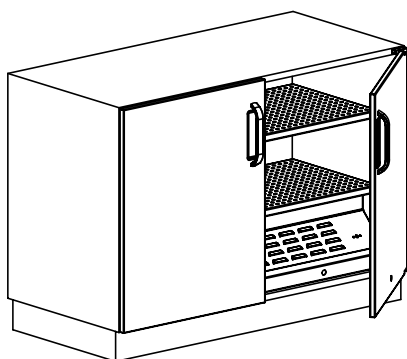

Heating cabinet – base cabinet

Model MFBW2

– NOT SUITABLE FOR STORING INFUSIONS –

2 lockable hinged doors
2 perforated cabinet shelves made of stainless steel
2 handles
Output 2000 W

Powder-coated

Stainless steel

Art. No.	Width mm	Depth mm	Height mm	Art. No.
54208401	900	580	700	54208601
54208403	1200	580	700	54208603
54208405	900	580	850	54208605
54208407	1200	580	850	54208607

MEGAPROGRESS WARMING DRAWER



Warming drawer for infusions

with perforated insert, switch panel and LED display for display of inside temperature
Capacity: drawer 450 mm wide: 12 x 1 ltr.
or 20 x 0.5 ltr. bottles; drawer 600 mm: 20 x 1 ltr.
or 32 x 0.5 ltr. bottles; drawer 660 mm wide: 24 x 1 ltr. or 36 x 0.5 ltr. bottles,
temperature adjustable from +33 °C to +37 °C, set to + 37 °C at factory,
overtemperature protection at 46 °C, self-limiting PTC heating element,
connected load: 220–240 V AC, 50–60 Hz, 400 Watt, 1.7 A;
frame height 233 mm, loading height: panel height minus 50 mm;
Class 1 medical product

Powder-coated					St. steel
Art. No.	Width mm	Depth mm	Height mm	Connected load Rating	Art. No.
34678401	450 – 660	580-680	350 – 375	220–240 V AC, 50–60 Hz, 400 Watt, 1.7 A	34678402



Warming drawer for linens

with perforated insert, switch panel and LED display for display of inside temperature
Temperature adjustable from 40 °C to 65 °C,
overtemperature protection, self-limiting PTC heating element,
connected load: 220–240 V AC, 50–60 Hz, 400 Watt, 1.7 A;
frame height 233 mm, loading height: trim panel height minus 50 mm;
drawer capacity: 450 mm: 24 dm³, 600 mm: 34 dm³, 660 mm: 40 dm³

Powder-coated					St. steel
Art. No.	Width mm	Depth mm	Height mm	Connected load Rating	Art. No.
54306401	450 – 660	580	350 – 375	220–240 V AC, 50–60 Hz, 400 Watt, 1.7 A	54306402

MEGAPROGRESS **BASE CABINET FOR DRAIN**

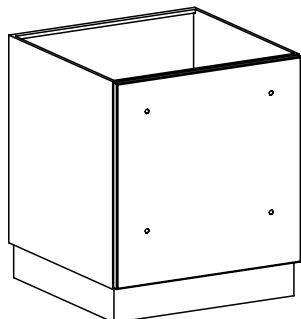

Drain base cabinet

Model **MBB**

for hospital drain
1 revision panel, removable

Powder-coated

Art. No.

Width
mm

Depth
mm

Height
mm

53766201

600

580

600

Stainless steel

Art. No.

54766201

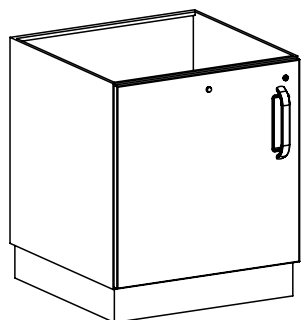

Drain base cabinet

Model **MFAB1**

for hospital drain
Pressure increase system can be integrated
1 hinged door, left or right-hand hinging
lockable
1 handle

Powder-coated

Art. No.

Width
mm

Depth
mm

Height
mm

53766101

600

580

600

Stainless steel

Art. No.

54766101

MEGAPROGRESS BASE CABINET FOR ULTRASOUND UNIT

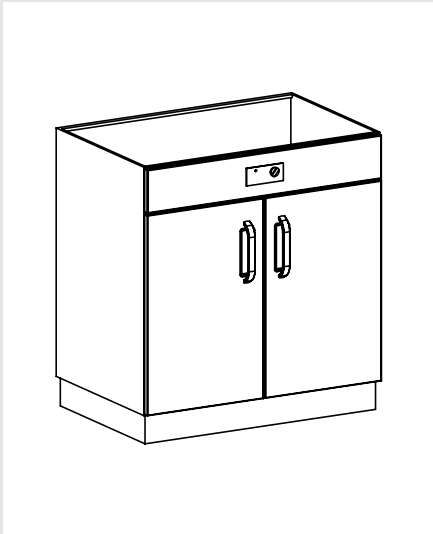

Base cabinet for installing an ultrasound unit

Model MFBBUS2

- 2 hinged doors
- 2 handles
- 1 panel 150 mm high with cut-out for ultrasound unit control device

Powder-coated				Stainless steel
Art. No.	Width mm	Depth mm	Height mm	Art. No.
53766301	900	580	850	54766301



Bandelin ZE 1058 ultrasound unit

Model SONOREX ZE 1058 ST 15

Control unit with time switch for 1–15 minutes and continuous operation complete with Bandelin SONOREX ZE1058 ultrasonic cleaning device

Art. No.	Width mm	Depth mm	Height mm	Description
542988	600	400	200	consisting of GT1000M HF generator, max. output 2 x 1200 W/period, frequency 35 KHz, with 16 swivelling elements including TE1058 swivelling basin made of stainless steel, drain on either left or right, dim. 600 x 400 x 200 mm suitable for DIN-STU and ISO standard wire mesh basket, including drain set, basket carrier, insert basket and lid

MEGAPROGRESS BASE CABINET FOR ULTRASOUND UNIT



Bandelin ZE 1058 DT ultrasound unit

with ST 30 DT digital control unit with temperature control
in swivelling basin and temperature sensor
complete with Bandelin SONOREX ZE1058 ultrasonic cleaning device

Art. No.	Width mm	Depth mm	Height mm	Description
543225	600	400	200	consisting of GT1000M HF generator, max. output 2 x 1200 W/period, frequency 35 KHz, with 16 swivelling elements, including TE1058 swivelling basin made of stainless steel, drain at right or left, dim. 600 x 400 x 200 mm suitable for DIN-STU and ISO standard wire mesh basket, including drain set, basket carrier, insert basket and lid



Bandelin ultrasound unit control unit

ST 30 DT

Art. No.	Description
MC0106	STE 30 DT digital control unit for SONOREX Super ZE 1058 ultrasound unit (ST 15 control unit is eliminated)

MEGAPROGRESS BASE CABINET FOR ULTRASOUND UNIT



SONOMIC MC 1000 ultrasound unit, complete

Model SONOMIC MC 1000

Bandelin ultrasound unit for hollow bodies for disinfection and cleaning of max. 12 washable MIC instruments with K 1000 MC basket and D 1000 MC lid
Table-top unit

Stainless steel

Art. No.	Width mm	Depth mm	Height mm	Thick- ness mm	Description
542989	860	490	415	2	Swivelling basin, inside: 650 x 400 x 210/230* mm (LxWxD), *angled well bottom, working filling capacity: 35 ltr., drain: fitting with rotary handle operation, vibration system: 12 PZT large-area vibration system, ultrasound frequency: 40 kHz, peak ultrasound output: 2400 W, HF output: 600 W, maintenance heating 400 W, current consumption: 2.9 A, weight with basket and lid: 40 kg Stainless steel 1.4571, titanium- stabilised, 2 mm thick



Medisafe ultrasound unit, complete

Model MED 1134 SI Digital

complete with accessories,
for 6 to 12 hollow instruments

Art. No.	Width mm	Depth mm	Height mm	Description
542990	656	301	156	Cut-out dimensions: 656 x 301 mm Basin dimensions: 651 x 294 x 156 mm

MEGAPROGRESS GYNAECOLOGY CABINET

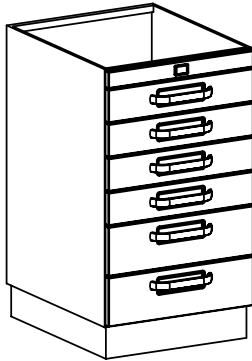

Gynaecology base cabinet

Model MLTW

2 drawers, 150 mm high each
4 drawers, 100 mm high each with preheating device
1 switch panel, 50 mm high
6 handles

Powder-coated

Art. No.	Width mm	Depth mm	Height mm
53763501	500	580	850
53763503	600	580	850

MEGAPROGRESS PLASTER BENCH SYSTEM AND ACCESSORIES

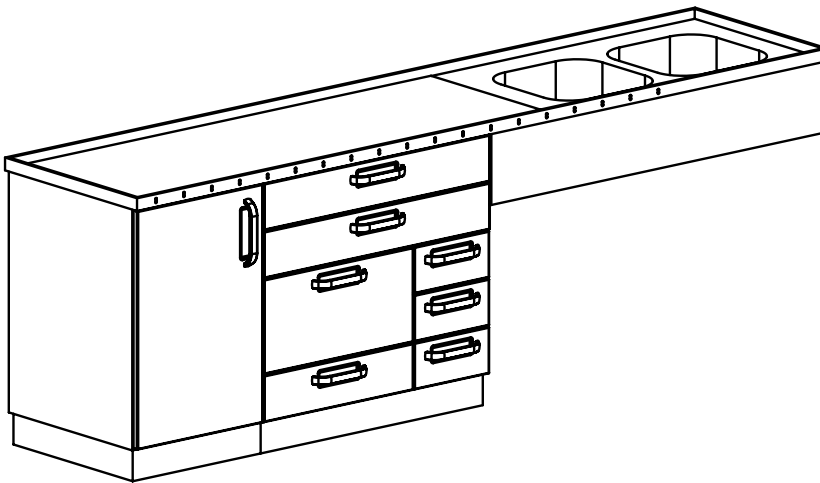

Plaster bench system

Model MGA 27/9

Stainless-steel table top with
2 welded-in basins
400 x 400 x 200 mm, with all-round profile edge and incline towards basins
Measuring marks stamped in on front turned down edge
1 base cabinet, 600 mm wide with hinged door, left or right-hand hinging, with 1 cabinet shelf made of stainless steel
1 base cabinet, 900 mm wide, with 6 drawers, 150 mm high each and 1 drawer, 300 mm high
in basin area
1 panel, 1200 mm long and 255 mm high
8 handles

Stainless steel

Art. No.	Width mm	Depth mm	Height mm
MC0135	2720	600	890

Art. No.

MC0035

**Measuring marks for
plaster bench**

MEGAPROGRESS **PLASTER BENCH SYSTEM AND ACCESSORIES**



1 1/2" tube overflow

Stainless steel

Art. No.	Description
369962	with rubber taper, basket strainer made of stainless steel without brazed union for basin depth of 200 mm, water level 180 mm



Drain connection

Synthetic

Art. No.	Description
369969	1 1/2" synthetic drain connection for double basin units

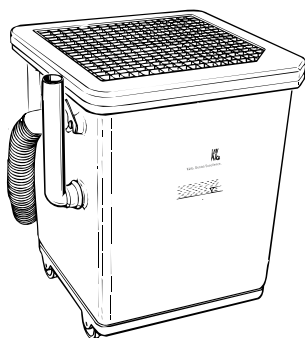

Plaster sedimentation basin, mobile

Model EWL 90

Art. No.	Width mm	Height mm	Description
543022	560	585	90 litre capacity

MEGAPROGRESS **PLASTER BENCH SYSTEM AND ACCESSORIES**

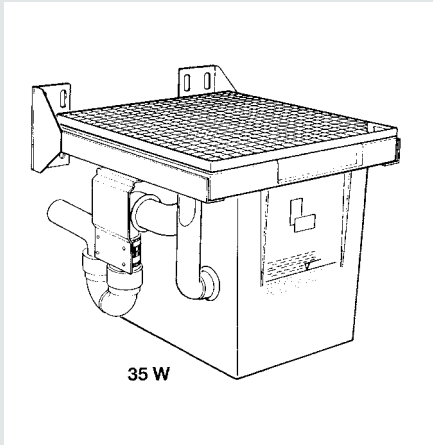

Synthetic plaster catch basin

Model 35 W

Art. No.	Description
146292	for wall mounting, can be pulled out for disposal

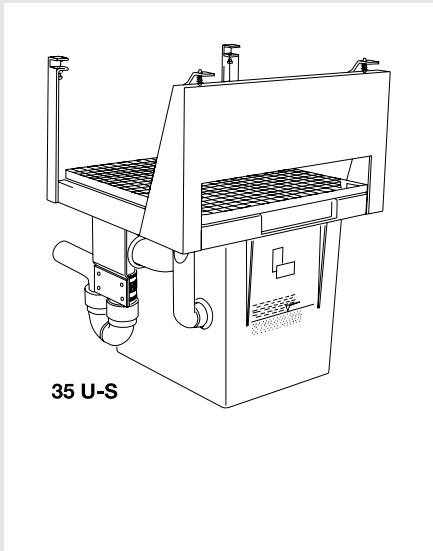

Synthetic plaster catch basin

Model 35 T

Art. No.	Description
146317	for cabinet mounting, can be pulled out for disposal

MEGAPROGRESS HIGH CABINET AS PER DIN STANDARD

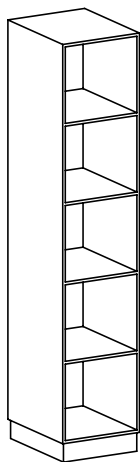

High cabinet – open

Model MOBH

Optional shelves

Powder-coated				Stainless steel
Art. No.	Width mm	Depth mm	Height mm	Art. No.
53767201	450	557	2100	54767201
53767202	600	557	2100	54767202
53767203	900	557	2100	54767203
53767204	1200	557	2100	54767204

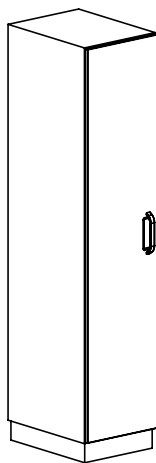

High cabinet with hinged door

Model MFBH1

1 hinged door, left or right-hand hinging
1 handle

Powder-coated				Stainless steel
Art. No.	Width mm	Depth mm	Height mm	Art. No.
53767301	450	580	2100	54767301
53767305	600	580	2100	54767305

MEGAPROGRESS HIGH CABINET AS PER DIN STANDARD

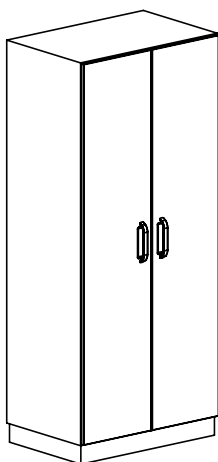

High cabinet with hinged doors

Model MFBH2

2 hinged doors
2 handles

Powder-coated				Stainless steel
Art. No.	Width mm	Depth mm	Height mm	Art. No.
53767401	900	580	2100	54767401
53767403	1200	580	2100	54767403

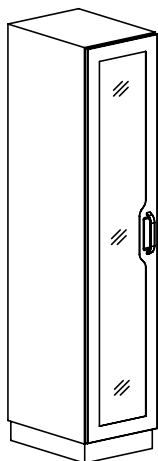

High cabinet with hinged door with glass insert

Model MGBH1

Hinged door with glass insert, left or right-hand hinging
1 handle

Powder-coated				Stainless steel
Art. No.	Width mm	Depth mm	Height mm	Art. No.
53762601	450	580	2100	54762601
53762605	600	580	2100	54762605

MEGAPROGRESS HIGH CABINET AS PER DIN STANDARD

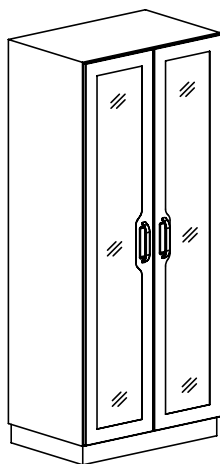

High cabinet with hinged doors with glass insert

Model MGBH2

2 hinged doors with glass insert
2 handles

Powder-coated				Stainless steel
Art. No.	Width mm	Depth mm	Height mm	Art. No.
53762701	900	580	2100	54762701
53762703	1200	580	2100	54762703

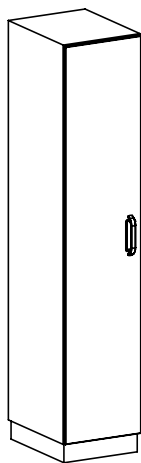

High drug cabinet

Model MFMH1

1 hinged door, left or right-hand hinging
1 handle
8 drug containers on the inside of the door (shelves shortened – in accordance with accessories)

Powder-coated				Stainless steel
Art. No.	Width mm	Depth mm	Height mm	Art. No.
53767901	600	580	2100	54767901

MEGAPROGRESS HIGH CABINET AS PER DIN STANDARD

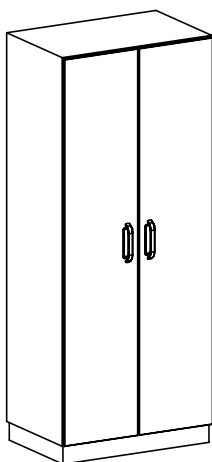

High drug cabinet

Model MFMH2

2 hinged doors

2 handles

16 drug containers on the inside of the door (shelves shortened – in accordance with accessories)

Powder-coated

Art. No.

Width
mm

Depth
mm

Height
mm

53768001

900

580

2100

53768003

1200

580

2100

Stainless steel

Art. No.

54768001

54768003

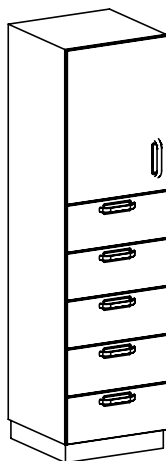

High drawer cabinet

Model MLTFH1

1 hinged door, left or right-hand hinging

5 drawers, 250 mm high each

6 handles

Powder-coated

Art. No.

Width
mm

Depth
mm

Height
mm

53768301

600

580

2100

Stainless steel

Art. No.

54768301

MEGAPROGRESS HIGH CABINET AS PER DIN STANDARD

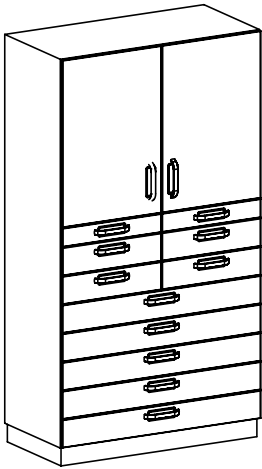

High drawer cabinet

Model MLTFH2/11

- 2 hinged doors
- 2 drawers, 100 mm high, 600 mm wide each
- 4 drawers, 150 mm high, 600 mm wide each
- 5 drawers, 150 mm high, 1200 mm wide each
- 13 handles

Powder-coated				Stainless steel
Art. No.	Width mm	Depth mm	Height mm	Art. No.
53790601	1200	580	2100	53790701

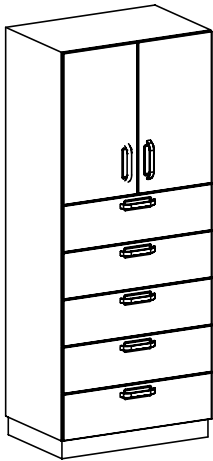

High drawer cabinet

Model MLTFH2

- 2 hinged doors
- 5 drawers, 250 mm high each
- 7 handles

Powder-coated				Stainless steel
Art. No.	Width mm	Depth mm	Height mm	Art. No.
53768401	900	580	2100	54768401

MEGAPROGRESS HIGH CABINET AS PER DIN STANDARD

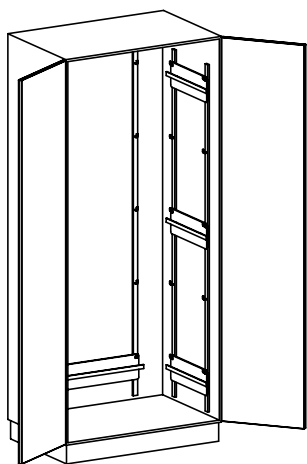

High OT accessories cabinet

Model MFOPH2

2 hinged doors

2 handles

Brackets and slide rails at left and rear (for 900 mm width), at left, right and rear (for 1200 mm width) on inner walls for mounting OT table accessories

Powder-coated

Art. No.	Width mm	Depth mm	Height mm
53770001	900	580	2100
53770003	1200	580	2100

Stainless steel

Art. No.
54770001
54770003

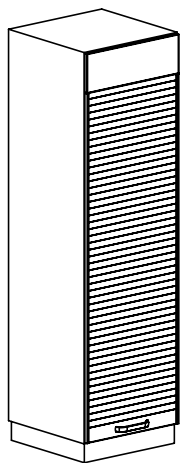

High cabinet with roller shutter

Model MRBH

with anodised aluminium roller shutter

Powder-coated

Art. No.	Width mm	Depth mm	Height mm
54296901	600	580	2100

MEGAPROGRESS HIGH CABINET AS PER DIN STANDARD

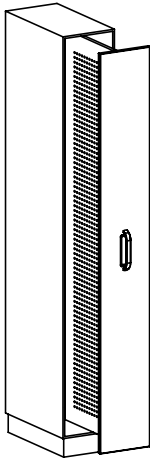

High cabinet with pull-out wall for instruments

Model MFIZM

with 1 pull-out perforated system wall (made of powder-coated steel), with handle, for hooking in a maximum of 60 system hooks per wall, individually adjustable, without accessories, max. total loading capacity: 130 kg

Powder-coated			
Art. No.	Width mm	Depth mm	Height mm
54238202	300	580	2100

System hooks for high cabinet with pull-out wall for instruments

Perforated wall hooks for perforated system wall, length 100 mm, hook-in bridge for 30 mm hole spacing, wire diameter 4 mm

Stainless steel
Art. No.
601790

MEGAPROGRESS HIGH CABINET AS PER DIN STANDARD

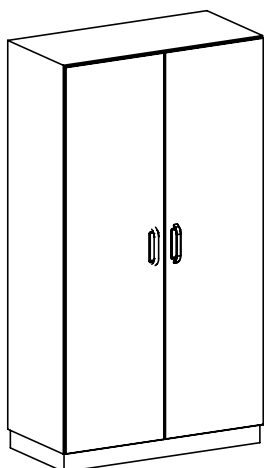

High cabinet with hinged doors for DIN module

Model EMFBH2

2 hinged doors
1 centre partition wall
2 handles
without equipment

Powder-coated					Stainless steel
Art. No.	Width mm	Depth mm	Height mm	Description	Art. No.
53771101	1200	580	2100	for mounting DIN modules, size 535 x 500 mm	54771101

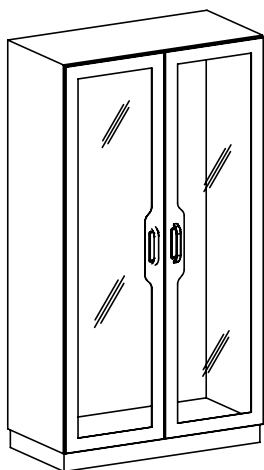

High cabinet with hinged doors with glass insert for DIN module

Model EMGBH2

2 hinged doors with glass insert
1 centre partition wall
2 handles
without equipment

Powder-coated					Stainless steel
Art. No.	Width mm	Depth mm	Height mm	Description	Art. No.
53790401	1200	580	2100	for mounting DIN modules, size 535 x 500 mm	53790501

MEGAPROGRESS IMPLANT CABINET

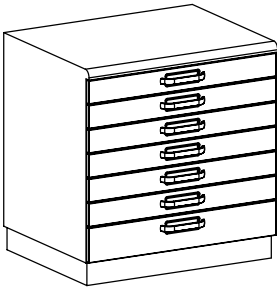

Implant base cabinet

Model MLTI

6 drawers with variable compartment dividers made of stainless steel for implants and accessories, 100 mm high each
1 drawer with variable compartment dividers made of stainless steel for implants and accessories, 150 mm high
all drawers with full extension; 7 handles, max. load per drawer: 40 kg if distributed evenly

Powder-coated				Stainless steel
Art. No.	Width mm	Depth mm	Height mm	Art. No.
53789101	900	680	890	53789301

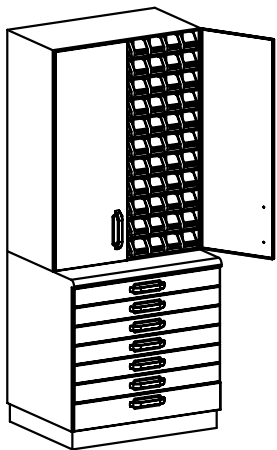

High implant cabinet

Model MLTFBHI

Implant cabinet
top:
1 top-mounted cabinet with 2 hinged doors
with synthetic small-parts housings for implants and accessories (top-mounted cabinet depth: 480 mm)
bottom:
6 drawers with variable compartment dividers made of stainless steel for implants and accessories, 100 mm high each, 1 drawer with variable metal compartment dividers for implants and accessories, 150 mm high; with cover made of stainless steel
9 handles
Max. load per drawer: 40 kg if distributed evenly

Powder-coated				Stainless steel
Art. No.	Width mm	Depth mm	Height mm	Art. No.
54200101	900	480/680	2100	54200201

MEGAPROGRESS IMPLANT CABINET

Implant base cabinet accessories

Art. No.	Description
610396	Drawer 1 + 2, H100, MLTI MPS
	10 x divider drawer 118 x 480 x 42 mm MPS 610378
	2 x divider drawer 208 x 480 x 42 mm MPS 610379
	14 x compartment divider 118 x 42 mm MPC 610384
	2 x compartment divider 208 x 42 mm MPC 610385
610397	Drawer 3 + 4, H100, MLTI MPS
	12 x divider drawer 118 x 480 x 42 mm MPS 610378
	2 x divider drawer 90 x 480 x 42 mm MPS 610377
610398	Drawer 5 + 6, H100, MLTI MPS
	4 x divider drawer 118 x 480 x 42 mm MPS 610378
	6 x divider drawer 562 x 160 x 42 mm MPS 610382
	12 x compartment divider 160 x 42 mm MPC 610386
610399	Drawer 7, H150, MLTI MPS
	6 x divider drawer 118 x 480 x 69 mm MPS 610381
	1 x divider drawer 90 x 480 x 69 mm MPS 610380
	7 x compartment divider 118 x 69 mm MPC 610387
146748	Partition walls for BK-20, yellow
146747	Small parts magazine BK-20, yellow 185 x 400 x 83 mm
146750	Partition walls for BK-30, yellow
146749	Small parts magazine BK-30, yellow 93 x 400 x 83 mm
542994	Labels for implant cabinet, BK 20 small-parts magazine for MRK 93
542995	Labels for implant cabinet, BK 30 small-parts magazine for MRK 186

Drawer 1 + 2

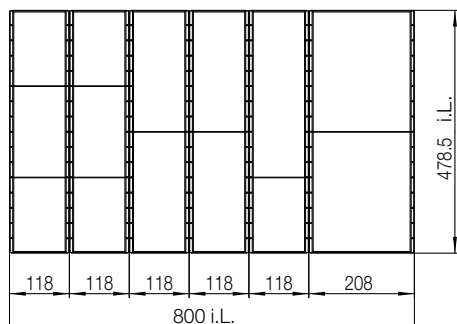

Drawer 3 + 4

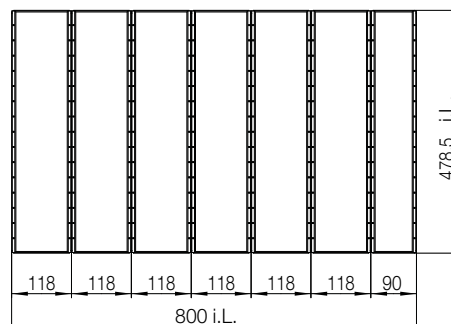

Drawer 5 + 6

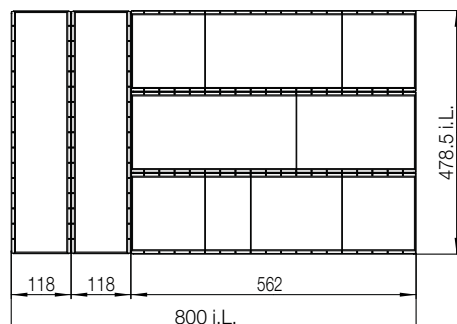

Drawer 7

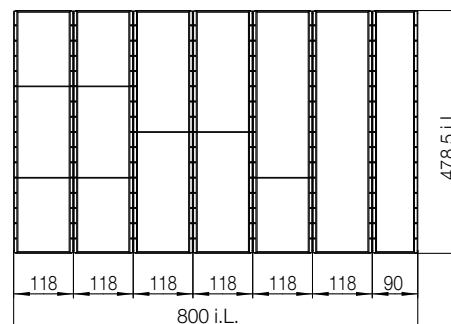

MEGAPROGRESS **ENDOSCOPY CABINET**

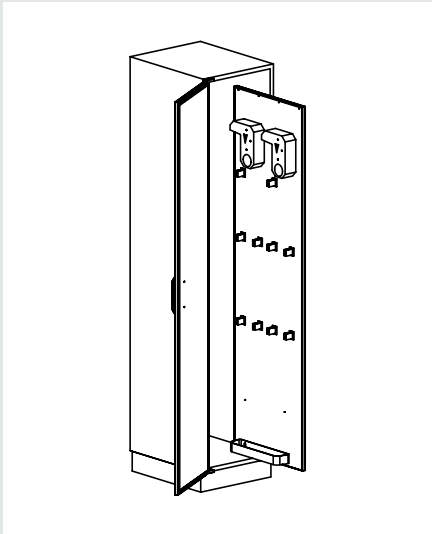

High endoscopy cabinet

Model **MFEZH1 1VT**

- 1 hinged door, left or right-hand hinging
- 1 handle
- 1 vertical partition wall, can be pulled out toward front, with 4 endoscope holders

Powder-coated				Stainless steel
Art. No.	Width mm	Depth mm	Height mm	Art. No.
53768501	300	580	2100	54768501
53768505	450	580	2100	54768505
53768509	600	580	2100	54768509

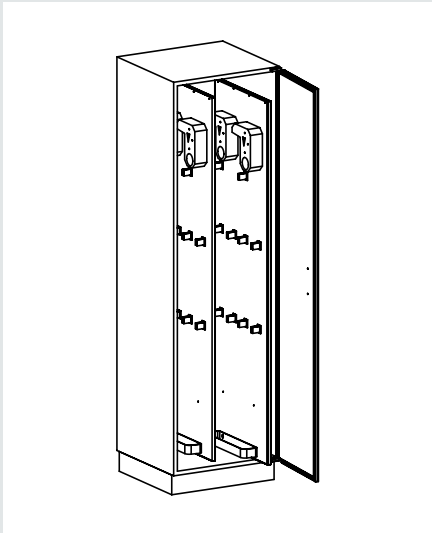

High endoscopy cabinet

Model **MFEZH1 2VT**

- 1 hinged door, left or right-hand hinging
- 1 handle
- 2 vertical partition walls, can be pulled out toward front, with 8 endoscope holders

Powder-coated				Stainless steel
Art. No.	Width mm	Depth mm	Height mm	Art. No.
53768601	600	580	2100	54768601

MEGAPROGRESS ENDOSCOPY CABINET

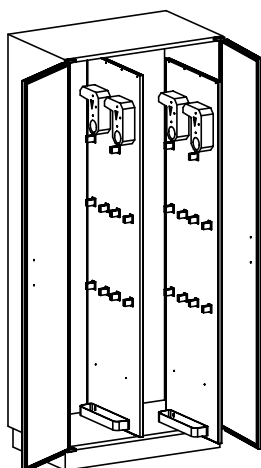

High endoscopy cabinet

Model MFEZH2 2VT

2 hinged doors
2 handles
2 vertical partition walls, can be pulled out toward front,
with 8 endoscope holders

Powder-coated

Art. No.

Width
mm

Depth
mm

Height
mm

53768701

900

580

2100

Stainless steel

Art. No.

54768701

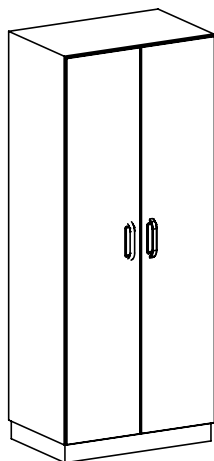

High endoscopy cabinet

Model MFEZH2 3VT

2 hinged doors
2 handles
3 vertical partition walls, can be pulled out toward front,
with 12 endoscope holders

Powder-coated

Art. No.

Width
mm

Depth
mm

Height
mm

53768801

900

580

2100

Stainless steel

Art. No.

54768801

MEGAPROGRESS **ENDOSCOPY CABINET**

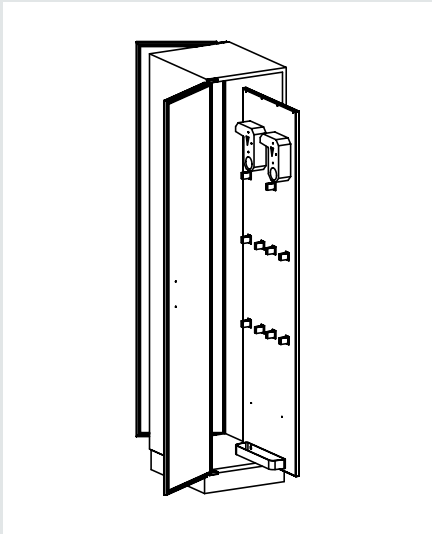

High endoscopy cabinet

Model MFEZ DRH 1VT

2 hinged doors as pass-through cabinet
2 handles
1 vertical partition wall, can be pulled out on both sides,
with 4 endoscope holders

Powder-coated				Stainless steel
Art. No.	Width mm	Depth mm	Height mm	Art. No.
54303201	450	600	2100	53303201

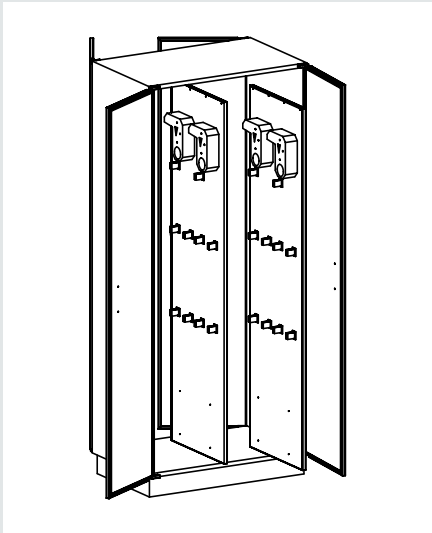

High endoscopy cabinet

Model MFEZ DRH 2VT

4 hinged doors as pass-through cabinet
4 handles
2 vertical partition walls, can be pulled out on both sides,
with 8 endoscope holders

Powder-coated			
Art. No.	Width mm	Depth mm	Height mm
54303301	600	600	2100

MEGAPROGRESS **ENDOSCOPY CABINET**

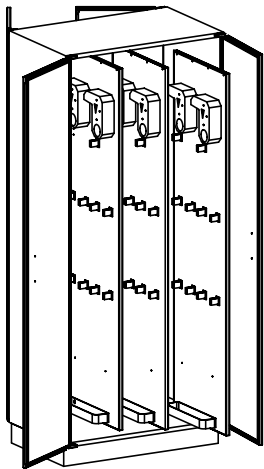

High endoscopy cabinet

Model MFEZ DRH 3VT

4 hinged doors as pass-through cabinet
4 handles
3 vertical partition walls, can be pulled out on both sides,
with 12 endoscope holders

Powder-coated

Art. No.	Width mm	Depth mm	Height mm
54303401	900	600	2100

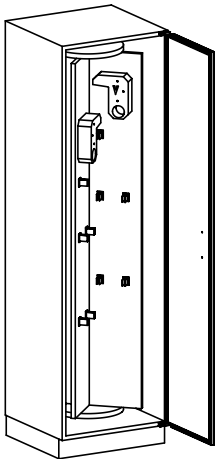

High endoscopy cabinet with carousel

Model MFEKH1

with carousel with 8 endoscope holders
1 hinged door, 1 handle

Powder-coated

Stainless steel

Art. No.	Width mm	Depth mm	Height mm	Art. No.
54303501	600	580	2100	54323001

MEGAPROGRESS **ENDOSCOPY CABINET**

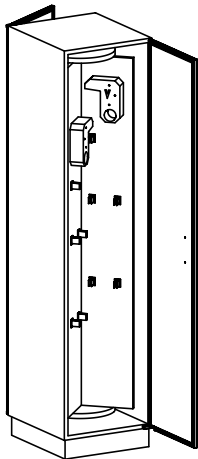

High endoscopy cabinet with carousel

Model **MFEKDRH1**

with carousel with 8 endoscope holders
2 hinged doors as pass-through cabinet, 2 handles

Powder-coated

Art. No.	Width mm	Depth mm	Height mm
54303601	600	600	2100

MEGAPROGRESS CATHETER CABINET

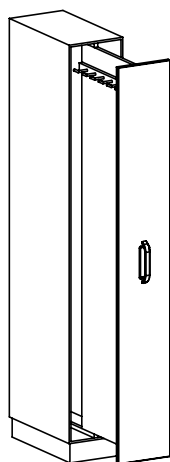

High catheter cabinet

Model MFHZH1 1VT

1 vertical extension with 12 hooks

1 handle

Optional:

U-shaped stainless-steel bar for holding catheter ends

Powder-coated

Art. No.

Width
mm

Depth
mm

Height
mm

54238201

300

580

2100

Stainless steel

Art. No.

54251801

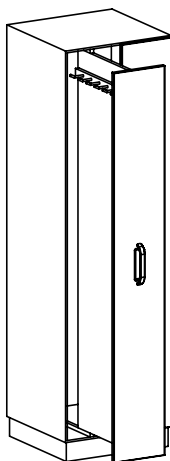

High catheter cabinet

Model MFHZH1 2VT

2 vertical extensions with 12 hooks each

2 handles

Optional:

U-shaped stainless-steel bar for holding catheter ends

Powder-coated

Art. No.

Width
mm

Depth
mm

Height
mm

54238001

600

580

2100

Stainless steel

Art. No.

54251901

MEGAPROGRESS CATHETER CABINET

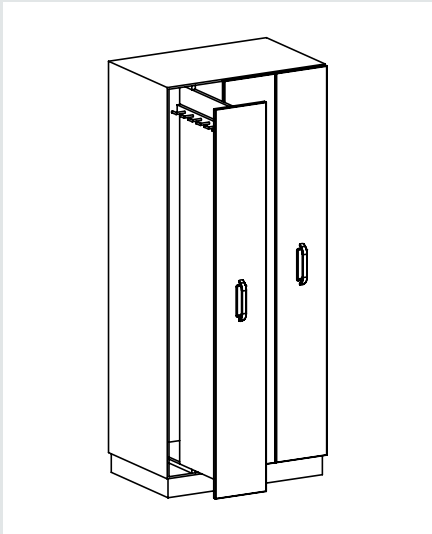

High catheter cabinet

Model MFHZH1 3VT

3 vertical extensions with 12 hooks each
3 handles
Optional:
U-shaped stainless-steel bar for holding catheter ends

Powder-coated				Stainless steel
Art. No.	Width mm	Depth mm	Height mm	Art. No.
54238101	900	580	2100	54252001

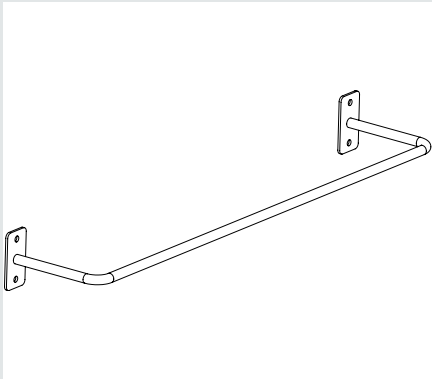

Bar for holding catheter ends

U-shaped bar for vertical extensions

Stainless steel
Art. No.
604513

MEGAPROGRESS DRUG CABINET

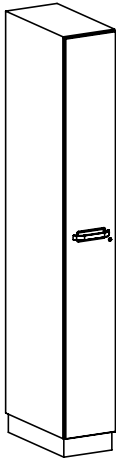

High drug cabinet

Model MLTAH/1

1 vertical drug pull-out, 300 mm wide, lockable,
10 adjustable compartment inserts and 40 crosswise dividers made of Plexiglas
1 handle

Powder-coated

Art. No.

Width
mm

Depth
mm

Height
mm

53768901

300

580

2100

Stainless steel

Art. No.

54768901

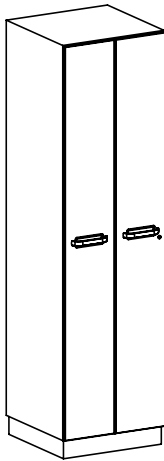

High drug cabinet

Model MLTAH/2

2 vertical drug pull-outs, 300 mm wide each,
with central lock,
20 adjustable compartment inserts and 80 crosswise dividers made of Plexiglas
2 handles

Powder-coated

Art. No.

Width
mm

Depth
mm

Height
mm

53769001

600

580

2100

Stainless steel

Art. No.

54769001

MEGAPROGRESS DRUG CABINET

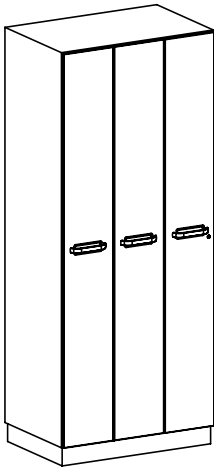

High drug cabinet

Model MLTAH/3

3 vertical drug pull-outs, 300 mm wide each,
with central lock,
30 adjustable compartment inserts and 12 crosswise dividers made of Plexiglas
3 handles

Powder-coated				Stainless steel
Art. No.	Width mm	Depth mm	Height mm	Art. No.
53769101	900	580	2100	54769101

MEGAPROGRESS PRACTICE CABINET

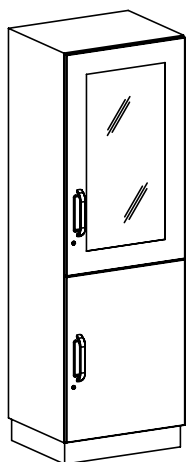

Practice cabinet

Model MPFG1

top: 1 hinged door with glass insert, left or right-hand hinging
 bottom: 1 hinged door, left or right-hand hinging
 lockable
 4 glass cabinet shelves
 2 handles

Powder-coated

Art. No.	Width mm	Depth mm	Height mm
53789801	600	480	1750

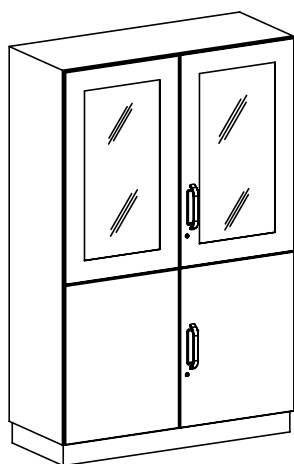

Practice cabinet

Model MPFG2

top: 2 doors with glass insert and stop bar,
 with 4 glass cabinet shelves
 bottom: 2 doors with stop bar, lockable
 2 handles

Powder-coated

Art. No.	Width mm	Depth mm	Height mm
53789901	1200	480	1750

MEGAPROGRESS HIGH CABINET FOR REFRIGERATION UNITS

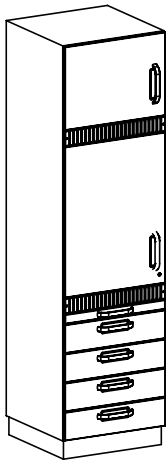

High cabinet for drug refrigerator

Model MLTKH

equipped for the installation of a drug refrigerator (centre),
Kirsch Med. 85, 80 ltr., with front-mounted door, flush with front, lockable,
1 hinged door at top, left or right-hand hinging
bottom: 1 pull-out worktop 50 mm high, 4 drawers, 150 high each
7 handles

Powder-coated

Art. No.

Width
mm

Depth
mm

Height
mm

53769201

600

580

2100

Stainless steel

Art. No.

54769201

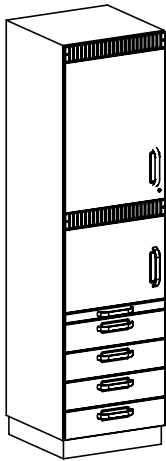

High cabinet for drug refrigerator

Model MLTKOH

equipped for the installation of a drug refrigerator (top),
Kirsch Med. 85, 80 ltr., with front-mounted door, flush with front, lockable,
1 hinged door in middle, left or right-hand hinging
bottom: 1 pull-out worktop 50 mm high, 4 drawers, 150 high each
7 handles

Powder-coated

Art. No.

Width
mm

Depth
mm

Height
mm

53769301

600

580

2100

Stainless steel

Art. No.

54769301

MEGAPROGRESS HIGH CABINET FOR REFRIGERATION UNITS

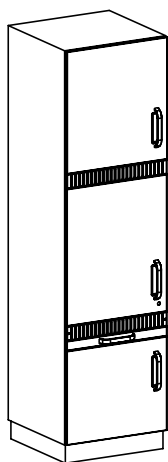

High cabinet for drug refrigerator

Model MFBKH

equipped for the installation of a drug refrigerator (centre),
Kirsch Med. 85, 80 ltr., with front-mounted door, flush with front, lockable,
1 hinged door each at top and bottom, left or right-hand hinging
1 pull-out worktop at bottom, 50 mm high
4 handles

Powder-coated

Art. No.

Width
mm

Depth
mm

Height
mm

53769401

600

580

2100

Stainless steel

Art. No.

54769401

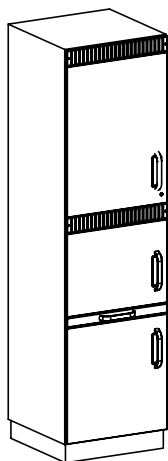

High cabinet for drug refrigerator

Model MFBKOH

equipped for the installation of a drug refrigerator (top),
Kirsch Med. 85, 80 ltr., with front-mounted door, flush with front, lockable,
1 hinged door in middle and bottom, left or right-hand hinging
1 pull-out worktop between, 50 mm high
4 handles

Powder-coated

Art. No.

Width
mm

Depth
mm

Height
mm

53769501

600

580

2100

Stainless steel

Art. No.

54769501

MEGAPROGRESS HIGH CABINET FOR REFRIGERATION UNITS

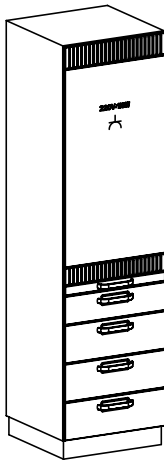

High cabinet for refrigerator

Model MLTHKH

equipped for the installation of a drug refrigerator (top),
Liebherr EK 1614, with freezer compartment, 127 ltr.,
bottom: 1 pull-out worktop, 50 mm high
1 drawer 150 mm high, 3 drawers, 200 high each
5 handles

Powder-coated				Stainless steel
Art. No.	Width mm	Depth mm	Height mm	Art. No.
53769601	600	580	2100	54769601

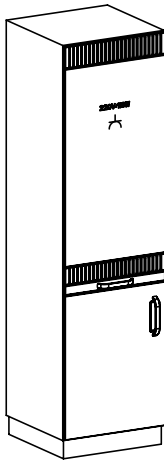

High cabinet for refrigerator

Model MFBHKH

equipped for the installation of a drug refrigerator (top),
Liebherr EK 1614, with freezer compartment, 127 ltr.,
bottom: 1 pull-out worktop, 50 mm high and 1 hinged door, left or right-hand hinging
2 handles

Powder-coated				Stainless steel
Art. No.	Width mm	Depth mm	Height mm	Art. No.
53769701	600	580	2100	54769701

MEGAPROGRESS HIGH CABINET FOR REFRIGERATION UNITS

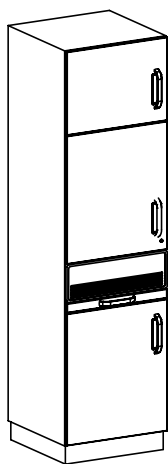

High cabinet for drug refrigerator

Model MFBKGBH

centre: compartment with front-mounted door, lockable, suitable for the installation of

- MED-100 drug refrigerator
- Froster MED-95
- BL-100 stored blood refrigerator

top: 1 hinged door, left or right-hand hinging

bottom: 1 pull-out worktop, 50 mm high and 1 hinged door, left or right-hand hinging
4 handles

Powder-coated				Stainless steel
Art. No.	Width mm	Depth mm	Height mm	Art. No.
53762101	600	580	2100	54762101

MEGAPROGRESS HIGH CABINET FOR REFRIGERATION UNITS

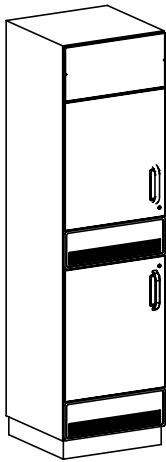

High cabinet for refrigeration units

Model MFBKGB2H

suitable for the installation of

- MED-100 drug refrigerator
- Froster MED-95
- BL-100 stored blood refrigerator

2 compartments with front-mounted door, lockable for refrigeration unit installation
2 handles

Powder-coated				Stainless steel
Art. No.	Width mm	Depth mm	Height mm	Art. No.
54202901	600	580	2100	54236201

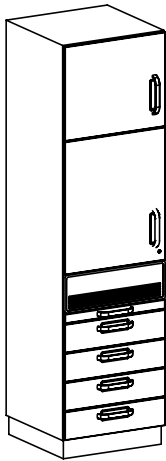

High cabinet for refrigeration unit

Model MLTKGBH

centre compartment with front-mounted door, lockable
suitable for the installation of

- MED-100 drug refrigerator
- Froster MED-95
- BL-100 stored blood refrigerator

top: 1 hinged door, left or right-hand hinging
bottom: 1 pull-out worktop 50 mm high, 4 drawers, 150 high each
7 handles

Powder-coated				Stainless steel
Art. No.	Width mm	Depth mm	Height mm	Art. No.
53762201	600	580	2100	54762201

MEGAPROGRESS HIGH CABINET FOR REFRIGERATION UNITS

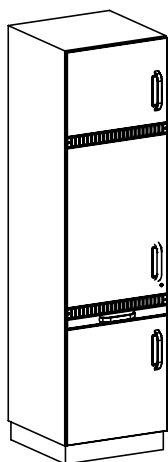

High cabinet for drug refrigerator

Model MFBKH1

equipped for the installation of a drug refrigerator (centre),
Kirsch Med. 125, 120 ltr., with front-mounted door, flush with front, lockable,
1 hinged door each at top and bottom, left or right-hand hinging
1 pull-out worktop at bottom, 50 mm high
4 handles

Powder-coated

Art. No.	Width mm	Depth mm	Height mm
54293501	600	580	2100

Stainless steel

Art. No.
54293701

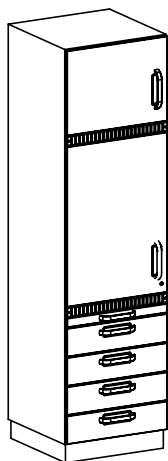

High cabinet for drug refrigerator

Model MLTKH1

equipped for the installation of a drug refrigerator (centre),
Kirsch Med. 125, 120 ltr., with front-mounted door, flush with front, lockable,
top: 1 hinged door, left or right-hand hinging
bottom: 1 pull-out worktop 50 mm high, 4 drawers, 150 high each
7 handles

Powder-coated

Art. No.	Width mm	Depth mm	Height mm
54293601	600	580	2100

Stainless steel

Art. No.
54293801

MEGAPROGRESS HIGH HEATING CABINET

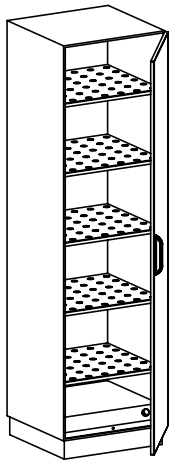

High heating cabinet

Model MFBWH1

– NOT SUITABLE FOR STORING INFUSIONS –

- 1 lockable hinged door, left or right-hand hinging
- 5 perforated cabinet shelves made of stainless steel
- 1 handle
- Output 1000 W

Powder-coated				Stainless steel
Art. No.	Width mm	Depth mm	Height mm	Art. No.
53770101	600	580	2100	54770101

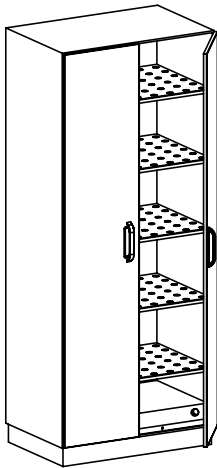

High heating cabinet

Model MFBWH2

– NOT SUITABLE FOR STORING INFUSIONS –

- 2 lockable hinged doors
- 5 perforated cabinet shelves made of stainless steel
- 2 handles
- Output 2000 W

Powder-coated				Stainless steel
Art. No.	Width mm	Depth mm	Height mm	Art. No.
54208301	900	580	2100	54208501
54208303	1200	580	2100	54208503

MEGAPROGRESS HIGH HEATING CABINET

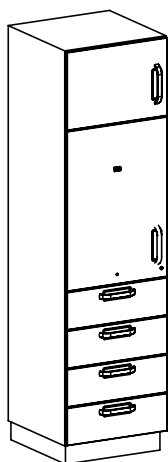

High cabinet with warming device

Model MLTWH1

– NOT SUITABLE FOR STORING INFUSIONS –

1 hinged door at top, left or right-hand hinging
centred 1 warming compartment, output 1000 W,
2 perforated cabinet shelves made of stainless steel, lockable,
door hinging on right or left
4 drawers below, 200 mm high each
6 handles

Powder-coated

Art. No.	Width mm	Depth mm	Height mm
53762301	600	580	2100

Stainless steel

Art. No.

54762301

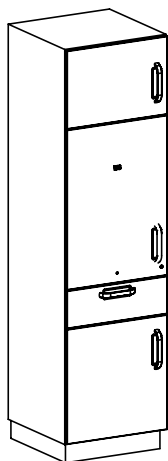

High cabinet with warming device

Model MFBSWH1

– NOT SUITABLE FOR STORING INFUSIONS –

1 hinged door each at top and bottom, left or right-hand hinging
centred 1 warming compartment, lockable,
output 1000 W, 2 perforated cabinet shelves made of stainless steel,
door hinging on right or left
1 drawer below, 200 mm high
4 handles

Powder-coated

Art. No.	Width mm	Depth mm	Height mm
53762401	600	580	2100

Stainless steel

Art. No.

54762401

MEGAPROGRESS COMBINATION CABINET

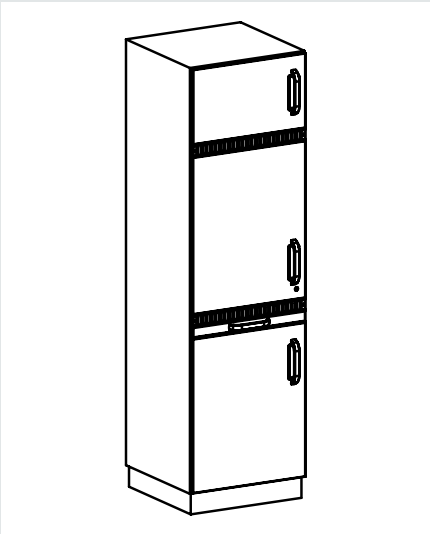

High cabinet with warming compartment and built-in refrigeration unit

Model MFBWKGH

– NOT SUITABLE FOR STORING INFUSIONS –

top: 1 hinged door, left or right-hand hinging
centre: lockable compartment for installing MED-85 refrigeration unit or Froster MED-70
bottom: built-in warming compartment, lockable,
with 2 perforated cabinet shelves made of stainless steel, output 1000 W
3 handles

Powder-coated				Stainless steel
Art. No.	Width mm	Depth mm	Height mm	Art. No.
53762001	600	580	2100	54762001

MEGAPROGRESS WARMING DRAWER



Warming drawer for infusions

with perforated insert, switch panel and LED display for display of inside temperature
Capacity: drawer 450 mm wide: 12 x 1 ltr.
or 20 x 0.5 ltr. bottles; drawer 600 mm: 20 x 1 ltr.
or 32 x 0.5 ltr. bottles; drawer 660 mm wide: 24 x 1 ltr. or 36 x 0.5 ltr. bottles,
temperature adjustable from +33 °C to +37 °C, set to + 37 °C at factory,
overtemperature protection at 46 °C, self-limiting PTC heating element,
connected load: 220–240 V AC, 50–60 Hz, 400 Watt, 1.7 A;
frame height 233 mm, loading height: trim panel height minus 50 mm;
Class 1 medical product

Powder-coated					St. steel
Art. No.	Width mm	Depth mm	Height mm	Connected load Rating	Art. No.
34678401	450 – 660	580	350 – 375	220–240 V AC, 50–60 Hz, 400 Watt, 1.7 A	34678402



Warming drawer for linens

with perforated insert, switch panel and LED display for display of inside temperature
Temperature adjustable from 40 °C to 65 °C,
overtemperature protection, self-limiting PTC heating element,
connected load: 220–240 V AC, 50–60 Hz, 400 Watt, 1.7 A;
frame height 233 mm, loading height: trim panel height minus 50 mm,
drawer capacity: 450 mm: 24 dm³, 600 mm: 34 dm³, 660 mm: 40 dm³

Powder-coated					St. steel
Art. No.	Width mm	Depth mm	Height mm	Connected load Rating	Art. No.
54306401	450 – 660	580-680	350 – 375	220–240 V AC, 50–60 Hz, 400 Watt, 1.7 A	54306402

MEGAPROGRESS WALL CABINET AS PER DIN STANDARD

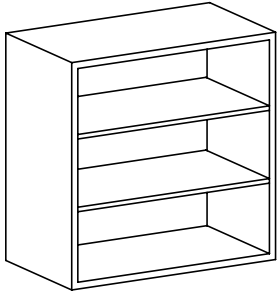

Open wall cabinet

Model MHO
Optional shelves

Powder-coated				Stainless steel
Art. No.	Width mm	Depth mm	Height mm	Art. No.
53766401	450	277	600	54766401
53766402	600	277	600	54766402
53766403	900	277	600	54766403
53766404	1200	277	600	54766404
53766409	450	357	600	54766409
53766410	600	357	600	54766410
53766411	900	357	600	54766411
53766412	1200	357	600	54766412
53766405	450	277	750	54766405
53766406	600	277	750	54766406
53766407	900	277	750	54766407
53766408	1200	277	750	54766408
53766413	450	357	750	54766413
53766414	600	357	750	54766414
53766415	900	357	750	54766415
53766416	1200	357	750	54766416

MEGAPROGRESS WALL CABINET AS PER DIN STANDARD

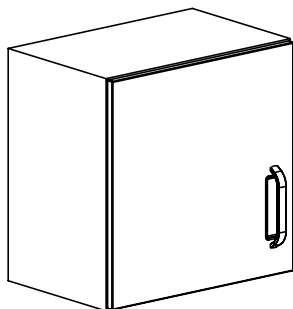

Wall cabinet with hinged door

Model MHF1

1 hinged door, left or right-hand hinging
1 handle

Powder-coated				Stainless steel
Art. No.	Width mm	Depth mm	Height mm	Art. No.
53766501	450	300	600	54766501
53766505	600	300	600	54766505
53766517	450	380	600	54766517
53766521	600	380	600	54766521
53766509	450	300	750	54766509
53766513	600	300	750	54766513
53766525	450	380	750	54766525
53766529	600	380	750	54766529

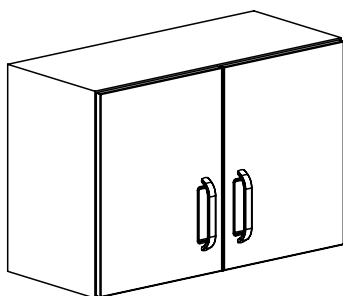

Wall cabinet with hinged doors

Model MHF2

2 hinged doors
2 handles

Powder-coated				Stainless steel
Art. No.	Width mm	Depth mm	Height mm	Art. No.
53766601	900	300	600	54766601
53766603	1200	300	600	54766603
53766609	900	380	600	54766609
53766611	1200	380	600	54766611
53766605	900	300	750	54766605
53766607	1200	300	750	54766607
53766613	900	380	750	54766613
53766615	1200	380	750	54766615

MEGAPROGRESS WALL CABINET AS PER DIN STANDARD

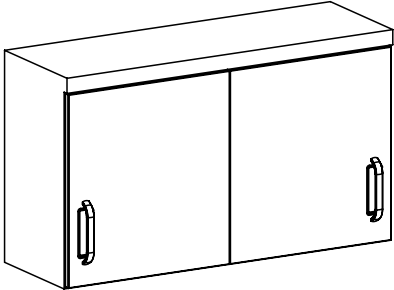

Wall cabinet with sliding doors

Model MHS

2 sliding doors
2 handles

Powder-coated				Stainless steel
Art. No.	Width mm	Depth mm	Height mm	Art. No.
53766701	900	300	600	54766701
53766703	1200	300	600	54766703
53766709	900	380	600	54766709
53766711	1200	380	600	54766711
53766705	900	300	750	54766705
53766707	1200	300	750	54766707
53766713	900	380	750	54766713
53766715	1200	380	750	54766715

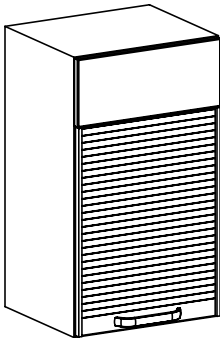

Wall cabinet with roller shutter

Model MHR

with anodised aluminium roller shutter

Powder-coated			
Art. No.	Width mm	Depth mm	Height mm
54301701	600	380	600
54301702	900	380	750

MEGAPROGRESS WALL CABINET AS PER DIN STANDARD

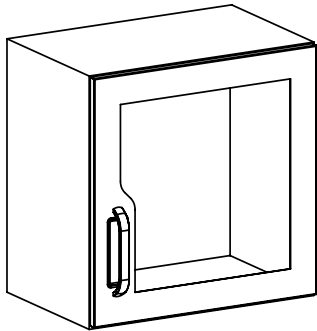

Wall cabinet with hinged door with glass insert

Model MHG1

1 hinged door with glass insert, left or right-hand hinging
1 handle
Optional glass shelf

Powder-coated				Stainless steel
Art. No.	Width mm	Depth mm	Height mm	Art. No.
54281601	450	300	600	54287101
54281602	600	300	600	54287102
54281605	450	380	600	54287105
54281606	600	380	600	54287106
54281603	450	300	750	54287103
54281604	600	300	750	54287104
54281607	450	380	750	54287107
54281608	600	380	750	54287108

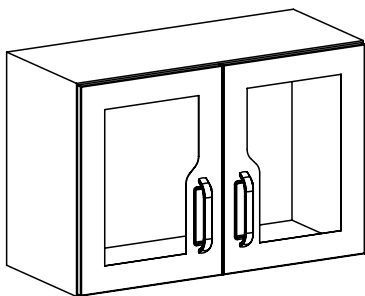

Wall cabinet with hinged doors with glass insert

Model MHG2

with 2 hinged doors with glass insert, 2 handles, optional glass shelf

Powder-coated				Stainless steel
Art. No.	Width mm	Depth mm	Height mm	Art. No.
54281501	900	300	600	54287201
54281502	1200	300	600	54287202
54281505	900	380	600	54287205
54281506	1200	380	600	54287206
54281503	900	300	750	54287203
54281504	1200	300	750	54287204
54281507	900	380	750	54287207
54281508	1200	380	750	54287208

MEGAPROGRESS WALL CABINET AS PER DIN STANDARD

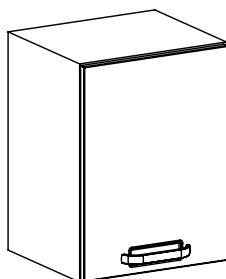

Wall cabinet with folding door

Model MHK

1 folding door
1 handle

Powder-coated

Art. No.

Width
mm

Depth
mm

Height
mm

53766801

450

380

600

53766803

600

380

600

53766807

450

380

750

53766809

600

380

750

Stainless steel

Art. No.

54766801

54766803

54766807

54766809

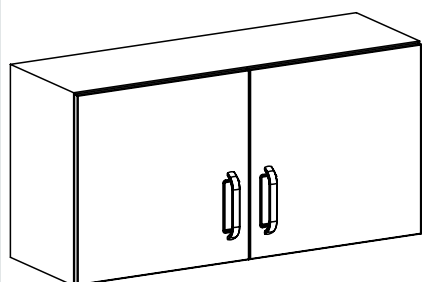

Wall cabinet with hinged doors for DIN module

Model EMHF2

2 hinged doors
1 centre partition wall
2 handles
for mounting DIN modules, size 538 x 250 mm
without equipment

Powder-coated

Art. No.

Width
mm

Depth
mm

Height
mm

53770801

1200

380

600

Stainless steel

Art. No.

54770801

MEGAPROGRESS TOP-MOUNTED CABINET AS PER DIN STANDARD

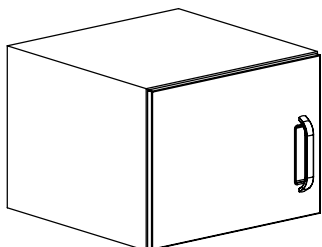

Top-mounted cabinet with hinged door

Model MFBA1

1 hinged door, left or right-hand hinging
1 handle

Powder-coated				Stainless steel
Art. No.	Width mm	Depth mm	Height mm	Art. No.
53767001	450	580	450	54767001
53767013	600	580	450	54767013
53767005	450	580	600	54767005
53767017	600	580	600	54767017
53767009	450	580	750	54767009
53767021	600	580	750	54767021

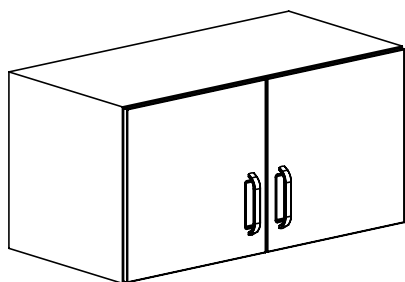

Top-mounted cabinet with hinged doors

Model MFBA2

2 hinged doors
2 handles

Powder-coated				Stainless steel
Art. No.	Width mm	Depth mm	Height mm	Art. No.
53767101	900	580	450	54767101
53767107	1200	580	450	54767107
53767103	900	580	600	54767103
53767109	1200	580	600	54767109
53767105	900	580	750	54767105
53767111	1200	580	750	54767111

MEGAPROGRESS ISO MODULE BASE CABINET

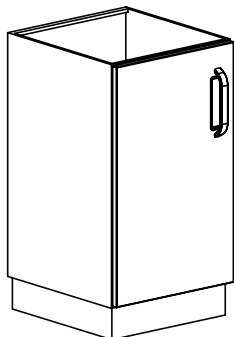

Base cabinet with hinged door

Model SMFB1

1 hinged door, left or right-hand hinging
1 handle
for mounting ISO modules, size 600 x 400 mm
without interior equipment

Powder-coated

Art. No.	Width mm	Depth mm	Height mm
53771209	660	480	700
53771201	460	680	700
53771213	660	480	850
53771205	460	680	850

Stainless steel

Art. No.
54771209
54771201
54771213
54771205

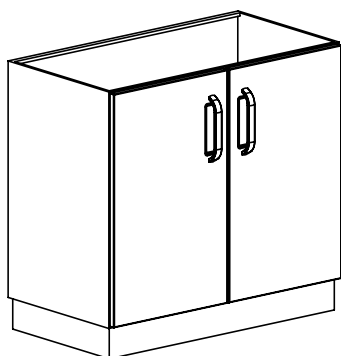

Base cabinet with hinged doors

Model SMFB2

2 hinged doors
2 handles
1 centre partition wall
for mounting ISO modules, size 600 x 400 mm
without interior equipment

Powder-coated

Art. No.	Width mm	Depth mm	Height mm
53771305	1320	480	700
53771301	920	680	700
53771307	1320	480	850
53771303	920	680	850

Stainless steel

Art. No.
54771305
54771301
54771307
54771303

MEGAPROGRESS ISO MODULE BASE CABINET

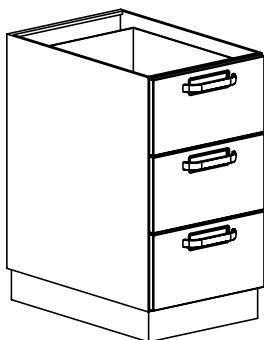

Base cabinet with pull-out extensions

Model SMLT/3

3 ISO pull-out extensions, 250 mm high each, hanging frame with full extension
3 handles for mounting ISO modules, size 600 x 400 mm

Powder-coated				Stainless steel
Art. No.	Width mm	Depth mm	Height mm	Art. No.
53789703	660	480	850	53790803
53789701	460	680	850	53790801

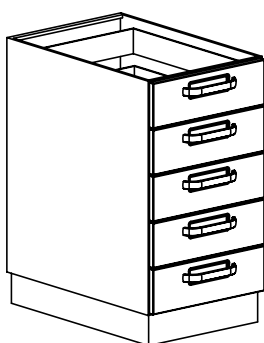

Base cabinet with pull-out extensions

Model SMLT/5

5 ISO pull-out extensions, 150 mm high each, hanging frame with full extension
5 handles for mounting ISO modules, size 600 x 400 mm

Powder-coated				Stainless steel
Art. No.	Width mm	Depth mm	Height mm	Art. No.
53789707	660	480	850	53790807
53789705	460	680	850	53790805

MEGAPROGRESS ISO MODULE BASE CABINET

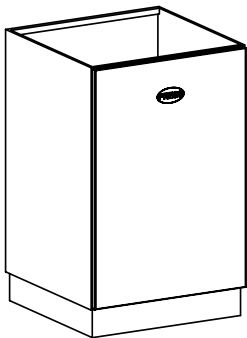

Base cabinet with tilt drawer

Model **SMKB**

1 tilt drawer with pneumatic door brake,
inside of door with fold-up hanging bars and shelf for synthetic garbage bags (60 ltr.)

Powder-coated				Stainless steel
Art. No.	Width mm	Depth mm	Height mm	Art. No.
53764902	660	480	850	54764902
53764901	460	680	850	54764901

MEGAPROGRESS ISO MODULE HIGH CABINET

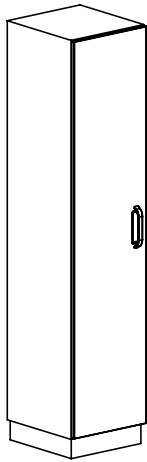

High cabinet with hinged door

Model SMFBH1

1 hinged door, left or right-hand hinging
1 handle
without interior equipment,
for mounting ISO modules, size 600 x 400 mm

Powder-coated				Stainless steel
Art. No.	Width mm	Depth mm	Height mm	Art. No.
53771801	460	680	2100	54771801
53771805	660	480	2100	54771805

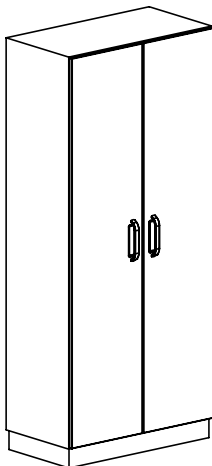

High cabinet with hinged doors

Model SMFBH2

2 hinged doors
2 handles
1 centre partition wall
without interior equipment,
for mounting ISO modules, size 600 x 400 mm

Powder-coated				Stainless steel
Art. No.	Width mm	Depth mm	Height mm	Art. No.
53771901	920	680	2100	54771901
53771903	1320	480	2100	54771903

MEGAPROGRESS ISO MODULE HIGH CABINET

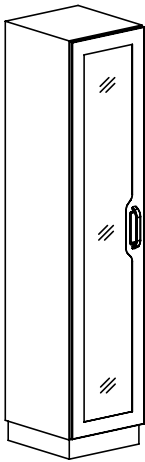

High cabinet with hinged door with glass insert

Model SMGBH1

1 hinged door with glass insert, left or right-hand hinging
1 handle
without interior equipment,
for mounting ISO modules, size 600 x 400 mm

Powder-coated				Stainless steel
Art. No.	Width mm	Depth mm	Height mm	Art. No.
53763001	660	680	2100	54763001
53763005	660	480	2100	54763005

MEGAPROGRESS ISO MODULE HIGH CABINET

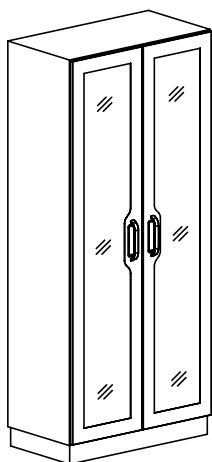

High cabinet with hinged doors with glass insert

Model SMGBH2

2 hinged doors with glass insert
2 handles
1 centre partition wall
without interior equipment,
for mounting ISO modules, size 600 x 400 mm

Powder-coated

Art. No.	Width mm	Depth mm	Height mm
53763101	920	680	2100
53763103	1320	480	2100

Stainless steel

Art. No.
54763101
54763103

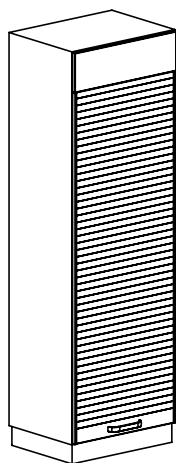

High cabinet with roller shutter

Model SMRBH

with anodised aluminium roller shutter
without interior equipment,
for mounting ISO modules, size 600 x 400 mm

Powder-coated

Art. No.	Width mm	Depth mm	Height mm	Description
54296902	460	680	2100	without centre partition wall
54296903	920	680	2100	with centre partition wall
54296904	660	480	2100	without centre partition wall
54296905	1320	480	2100	with centre partition wall

MEGAPROGRESS ISO MODULE WALL CABINET

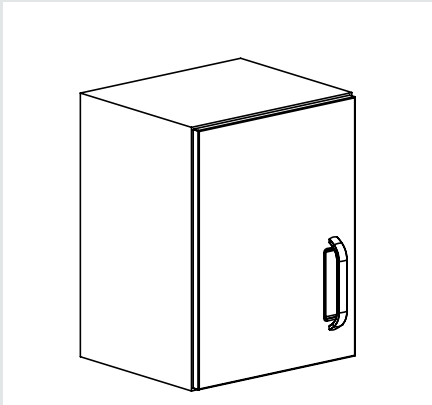

Wall cabinet with hinged door

Model SMHF1

1 hinged door, left or right-hand hinging
1 handle
without interior equipment,
for mounting ISO modules, size 300 x 400 mm

Powder-coated				Stainless steel
Art. No.	Width mm	Depth mm	Height mm	Art. No.
53771401	460	380	600	54771401

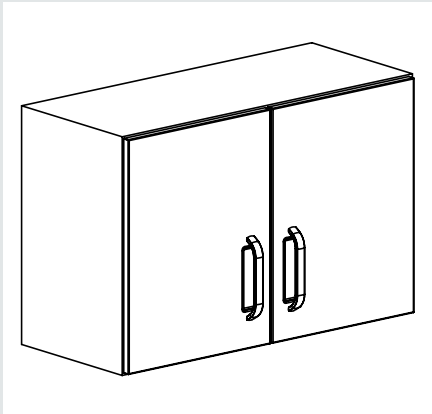

Wall cabinet with hinged doors

Model SMHF2

2 hinged doors
2 handles
1 centre partition wall
without interior equipment,
for mounting ISO modules, size 300 x 400 mm

Powder-coated				Stainless steel
Art. No.	Width mm	Depth mm	Height mm	Art. No.
53771501	920	380	600	54771501

MEGAPROGRESS ISO MODULE WALL CABINET

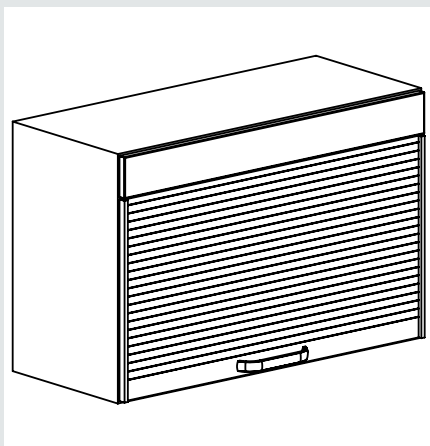

ISO wall cabinet with roller shutter

Model SMHR

with anodised aluminium roller shutter,
without interior equipment,
for mounting ISO modules, size 300 x 400 mm

Powder-coated

Art. No.	Width mm	Depth mm	Height mm	Description
54301703	460	380	600	without centre partition wall
54301704	920	380	600	with centre partition wall

MEGAPROGRESS ISO MODULE TOP-MOUNTED CABINET

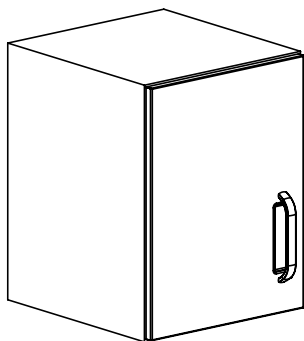

Top-mounted cabinet with hinged door

Model SMFBA1

1 hinged door, left or right-hand hinging
1 handle
without interior equipment,
for mounting ISO modules, size 600 x 400 mm

Powder-coated				Stainless steel
Art. No.	Width mm	Depth mm	Height mm	Art. No.
53771601	460	680	450	54771601
53771605	460	680	600	54771605
53771609	460	680	750	54771609
53771613	660	480	450	54771613
53771617	660	480	600	54771617
53771621	660	480	750	54771621

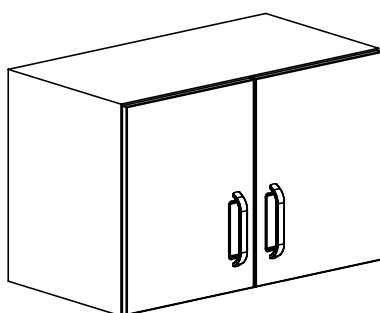

Top-mounted cabinet with hinged doors

Model SMFBA2

2 hinged doors
1 centre partition wall
2 handles
without interior equipment,
for mounting ISO modules, size 600 x 400 mm

Powder-coated				Stainless steel
Art. No.	Width mm	Depth mm	Height mm	Art. No.
53771701	920	680	450	54771701
53771703	920	680	600	54771703
53771705	920	680	750	54771705
53771707	1320	480	450	54771707
53771709	1320	480	600	54771709
53771711	1320	480	750	54771711

MEGAPROGRESS **MODULE EQUIPMENT**

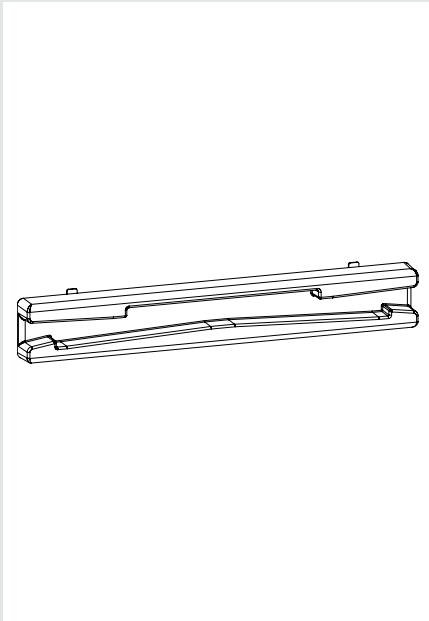

Multifunctional guide element

Synthetic guide rail with integrated clips,
15 kg loading capacity per element

Synthetic

Art. No.	Description
343954	for DIN and ISO cabinets with 380 mm cabinet depth Length 290 mm
343953	for ISO cabinets with 480 mm cabinet depth Length 390 mm
343952	for DIN cabinets with 580 mm cabinet depth Length 490 mm
343951	for ISO cabinets with 680 mm cabinet depth Length 590 mm

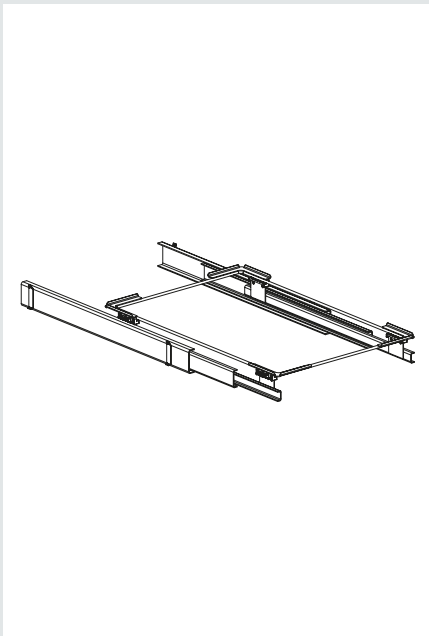

Multifunctional telescopic pull-out

Metal guides with 2 securing elements made of stainless steel
Ball-bearing castor model with pull-in mechanism and end lock
Over-extension
Universal holding frame made of stainless steel
Surface electropolished
Max. loading capacity of telescopic pull-out 30 kg

Stainless steel

Art. No.	Description
542385	for ISO cabinets with 480 mm depth Guide length: 390 mm, can be pulled out to 450 mm
542384	for ISO cabinets with 680 mm depth Guide length: 590 mm, can be pulled out to 650 mm

MEGAPROGRESS **STU HIGH CABINET**

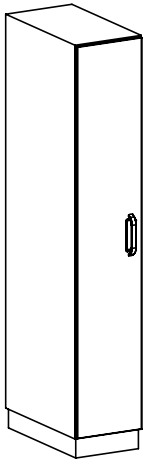

STU high cabinet with inner frame

Model CMFBHG1

with stainless-steel inner frame for mounting STU containers or STU baskets
with hinged door, left or right-handed door hinging,
cabinet without interior equipment, STU storage components optional,
1 handle,
1 segment for max. 11 x 1/2 STU

Powder-coated				Stainless steel
Art. No.	Width mm	Depth mm	Height mm	Art. No.
54293101	400	680	2100	54293301

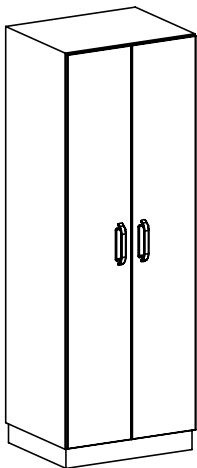

STU high cabinet with inner frame

Model CMFBHG2

with stainless-steel inner frame for mounting STU containers or STU baskets
with 2 hinged doors,
cabinet without interior equipment, STU storage components optional,
2 handles

Powder-coated					St. steel
Art. No.	Width mm	Depth mm	Height mm	Description	Art. No.
54293201	730	680	2100	2 segments for max. 22 x 1/2 STU	54293401
54293202	1060	680	2100	3 segments for max. 33 x 1/2 STU	54293402

MEGAPROGRESS **STU HIGH CABINET**

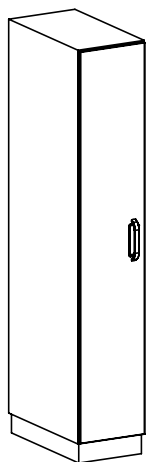

STU high cabinet with hinged door

Model CMFBH1

suitable for mounting STU containers or baskets, Wagner system
1 hinged door, left or right-hand hinging
1 handle
without interior equipment

Powder-coated

Art. No.

Width
mm

Depth
mm

Height
mm

53772101

375

680

2100

Stainless steel

Art. No.

54772101

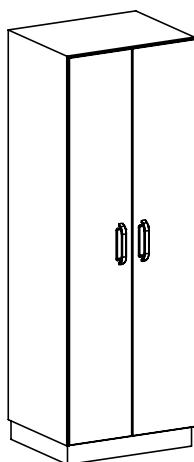

STU high cabinet with hinged doors

Model CMFBH2

suitable for mounting STU containers or baskets, Wagner system
2 hinged doors
1 centre partition wall
2 handles
without interior equipment

Powder-coated

Art. No.

Width
mm

Depth
mm

Height
mm

53772201

750

680

2100

Stainless steel

Art. No.

54772201

MEGAPROGRESS **ROLL-IN AND PASS-THROUGH CABINETS**

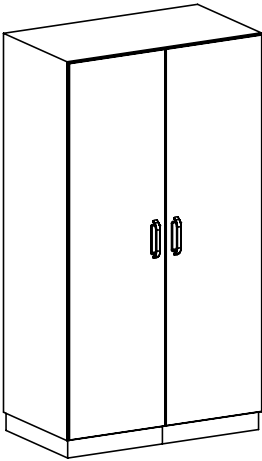

Roll-in cabinet

Model MFBHEE2

2 hinged doors with attached plinth
2 handles
Inside roll-in dimensions: 1080 x 820 x 2030 mm (W x D x H)

Powder-coated				Stainless steel
Art. No.	Width mm	Depth mm	Height mm	Art. No.
53762901	1200	920	2100	54762901

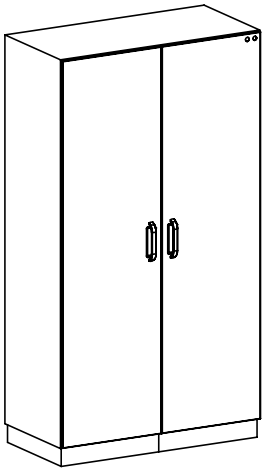

Roll-in, pass-through cabinet

Model MFBHDF2

2 x 2 opposing hinged doors with attached plinth and electromagnetic locking,
roll-up strip,
4 handles
Roll-in dimensions: 1080 x 820 x 2030 mm (W x D x H)

Powder-coated				Stainless steel
Art. No.	Width mm	Depth mm	Height mm	Art. No.
54239701	1200	920	2100	54238601

MEGAPROGRESS ROLL-IN AND PASS-THROUGH CABINETS

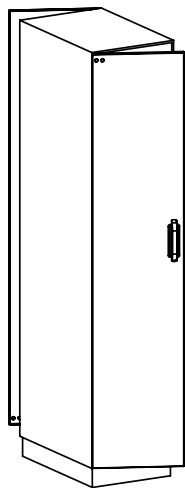

Pass-through cabinet

Model MFBDRH1

2 opposing hinged doors, left or right-hand hinging
2 handles with mutual electromagnetic locking, shelves optional

Powder-coated				Stainless steel
Art. No.	Width mm	Depth mm	Height mm	Art. No.
54200505	460	703	2100	54200805
54200501	600	703	2100	54200801

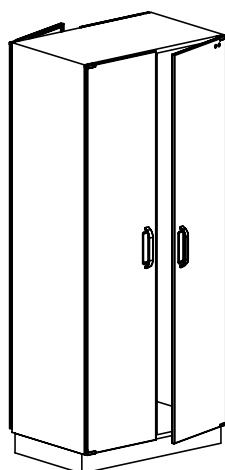

Pass-through cabinet

Model MFBDRH2

2 x 2 opposing hinged doors
4 handles with mutual electromagnetic locking
Optional shelves

Powder-coated				Stainless steel
Art. No.	Width mm	Depth mm	Height mm	Art. No.
54200603	900	703	2100	54200703
54200601	1200	703	2100	54200701

MEGAPROGRESS ROLL-IN AND PASS-THROUGH CABINETS

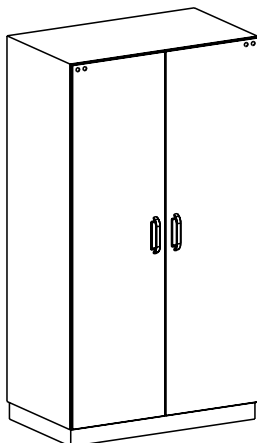

Pass-through cabinet

Model MFBDRH2 MW

2 x 2 opposing hinged doors
Centre partition wall
4 handles with mutual electromagnetic locking
Optional shelves

Powder-coated				Stainless steel
Art. No.	Width mm	Depth mm	Height mm	Art. No.
54305201	1200	703	2100	54243801

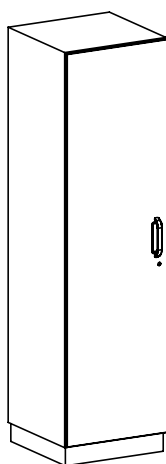

Pass-through cabinet

Model MFBHDR1

2 opposing hinged doors, left or right-hand hinging, lockable
Optional shelves

Powder-coated					St. steel
Art. No.	Width mm	Depth mm	Height mm	Description	Art. No.
54239505	460	703	2100	2 handles, espagnolette lock with key actuation	54236705
54239511	460	703	2100	with espagnolette lock with rotary knob	54236711
54239501	600	703	2100	2 handles, espagnolette lock with key actuation	54236701
54239509	600	703	2100	with espagnolette lock with rotary knob	54236709

MEGAPROGRESS **ROLL-IN AND PASS-THROUGH CABINETS**

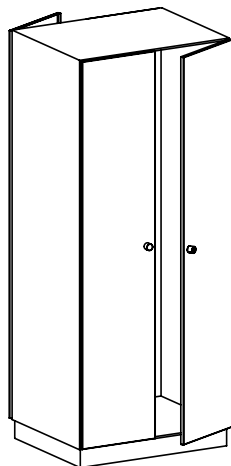

Pass-through cabinet

Model **MFBHDF2**

2 x 2 opposing hinged doors
Centre partition wall
4 handles
Optional shelves

Powder-coated					St. steel
Art. No.	Width mm	Depth mm	Height mm	Description	Art. No.
54239603	900	703	2100	4 handles, espagnolette lock with key actuation	54239403
54239606	900	703	2100	with espagnolette lock with rotary knob	54239406
54239601	1200	703	2100	4 handles, espagnolette lock with key actuation	54239401
54239605	1200	703	2100	with espagnolette lock with rotary knob	54239405

MEGAPROGRESS PASS-THROUGH COMPARTMENT SYSTEM

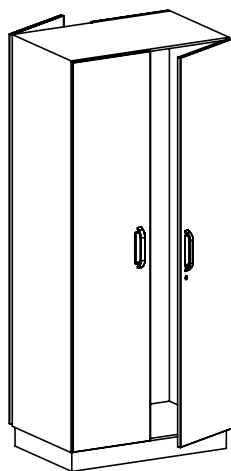

Pass-through cabinet

Model MFBHDR2 MW

2 x 2 opposing hinged doors
Centre partition wall, lockable

Powder-coated

St. steel

Art. No.	Width mm	Depth mm	Height mm	Description	Art. No.
54243401	1200	703	2100	Centre partition wall, 4 handles, espagnolette lock with key actuation	54243401
54243501	1200	703	2100	Centre partition wall, espagnolette lock with rotary knob	54243405

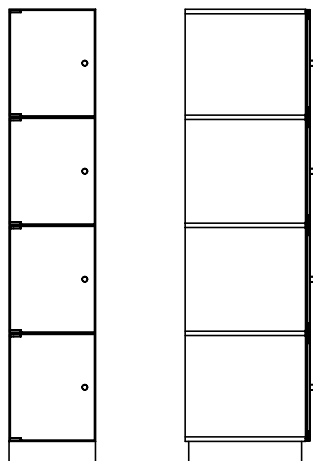

Pass-through compartment system

Model MDF

self-supporting sturdy design, suitable for installation
in wall openings or as room divider

Model:

4 compartments (dimensions of interior compartment: 358 x 657 x 457 mm),
1 hinged door per compartment at front, right or left-hand hinging
lockable with rotary knob

Powder-coated

St. steel

Art. No.	Width mm	Depth mm	Height mm	Description	Art. No.
54311201	400	680	2100	Rear open	53799801
54311202	400	703	2100	Rear with hinged door	53799802

MEGAPROGRESS PASS-THROUGH COMPARTMENT SYSTEM

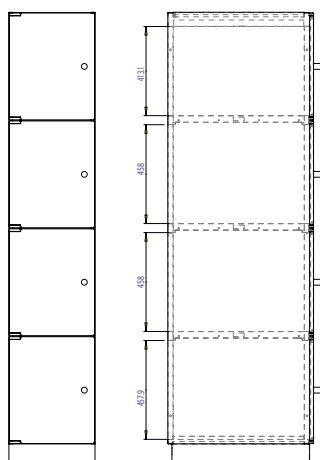

Pass-through compartment system

Model MDFE

self-supporting sturdy design, suitable for installation in wall openings or as room divider

Model:

4 compartments, 1 hinged door with rotary knob per compartment at front, right or left-hand hinging

one hinged door at rear, mutual electromagnetic locking

Interior compartment dimensions: 350 x 625 x 455 mm

Top compartment 410 mm high

Powder-coated

Stainless steel

Art. No.	Width mm	Depth mm	Height mm	Art. No.
54307101	400	703	2100	54241801

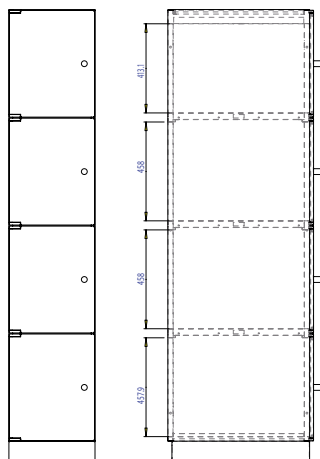

Pass-through compartment system

Model SMDF

for ISO dimensions, self-supporting sturdy design, suitable for installation in wall openings or as room divider

Model:

4 compartments, 1 hinged door with rotary knob per compartment at front, right or left-hand hinging

Compartment dimensions: 410 x 625 x 455 mm

Powder-coated

St. steel

Art. No.	Width mm	Depth mm	Height mm	Description	Art. No.
54311301	480	680	2100	Rear open	53799901
54311302	480	703	2100	Rear with hinged door	53799902

MEGAPROGRESS STU ACCESSORIES



STU support bracket

for hooking into pins, for STU cabinets with inner frame and STU shelf
for storing containers and sterile equipment baskets

Stainless steel

Art. No.	Width mm	Depth mm	Height mm
542889	60	600	50

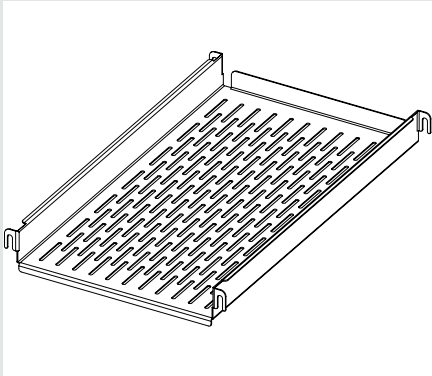

Perforated shelf

for hooking into pins, for STU cabinets with inner frame and STU shelf
for storing containers and sterile equipment baskets

Stainless steel

Art. No.
600777

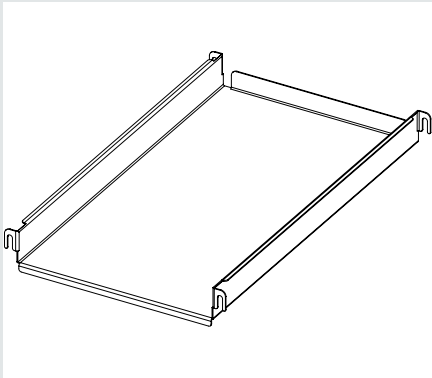

Closed shelf

for hooking into pins, for STU cabinets with inner frame and STU shelf
for storing containers and sterile equipment baskets

Stainless steel

Art. No.
600778

MEGAPROGRESS STU ACCESSORIES

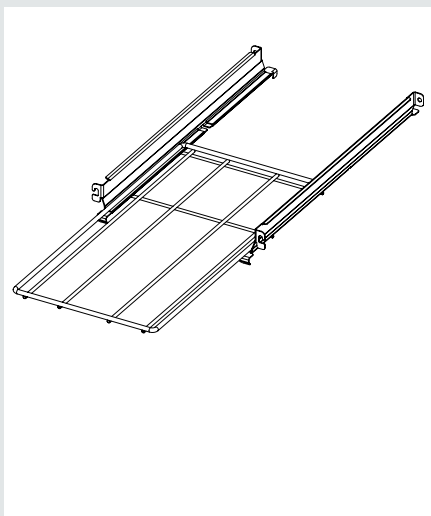

STU heavy-load extension

for storing containers and sterile equipment baskets.

Consists of:

1 rotary shelf and 2 support brackets with synthetic sliding rail, with 2/3 extension and pull-out stop, for hanging

Max. load-bearing capacity 25 kg

Stainless steel

Art. No.	Width mm	Depth mm	Description
542529	292	600	for hooking into pins, for STU cabinets with inner frame, STU shelf and container transport trolley
542952	292	600	for STU cabinet with laid-on slotted grid rails, with shelf carriers

MEGAPROGRESS PLINTH

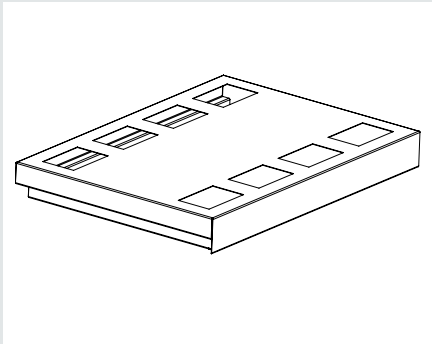

System plinth

Powder-coated			Stainless steel
Art. No.	Description	Cabinet depth mm	Art. No.
54310401	maximum width 2000 mm (2400 mm for stainless steel) per plinth, 100 mm high	457-657	54310502

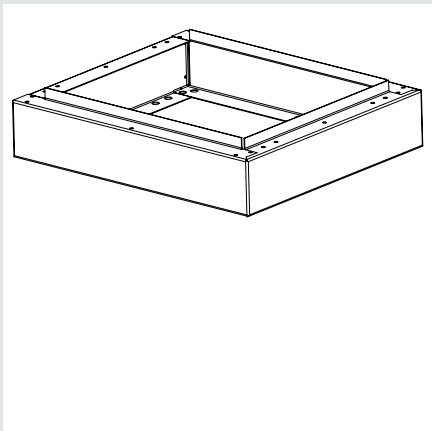

Cabinet individual plinth

Powder-coated				Stainless steel
Art. No.	Width mm	Height mm	Cabinet depth mm	Art. No.
MC0148	450/460	100	457/657	MC0152
MC0149	600/660	100	457/657	MC0153
MC0150	900/920	100	457/657	MC0154
MC0151	1200/1320	100	457/657	MC0155

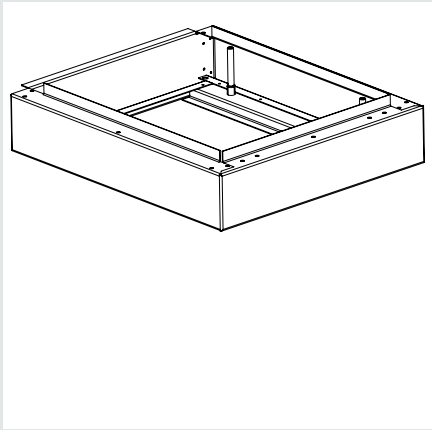

Cabinet individual plinth, levelable

Powder-coated				Stainless steel
Art. No.	Width mm	Height mm	Cabinet depth mm	Art. No.
MC0158	450/460	100	457/657	MC0162
MC0159	600/660	100	457/657	MC0163
MC0160	900/920	100	457/657	MC0164
MC0161	1200/1320	100	457/657	MC0165

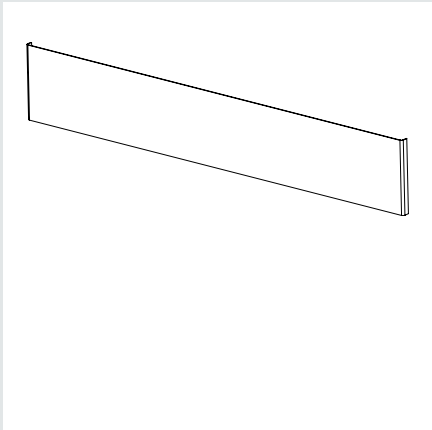

Metal plinth plate

Powder-coated		Stainless steel
Art. No.		Art. No.
MC0138		MC0140

MEGAPROGRESS CABINET SHELF

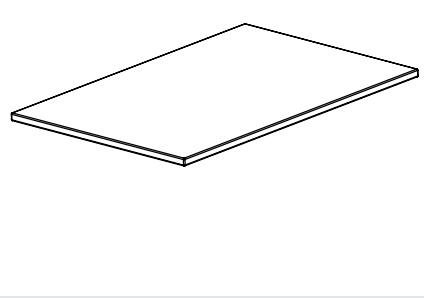

ISO cabinet shelf

for use with multifunction guide element and telescopic slide

Wood/synthetic		Shelf dimensions	
Art. No.	Width mm	Depth mm	Height mm
344493	600	400	12

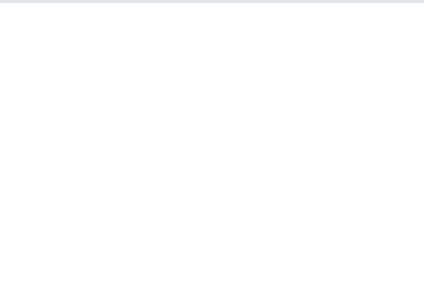

ISO cabinet shelf for carrier wall

on underside with 4-sided fold-in, single-walled

Powder-coated		Shelf dimensions		Stainless steel
Art. No.	Width mm	Depth mm	Height mm	Art. No.
608727	600	400	12	345766



ISO cabinet shelves for cabinet with slotted grid

Single-walled, with shelf carrier set

Powder-coated		Shelf dimensions		Stainless steel
Art. No.	Width mm	Depth mm	Height mm	Art. No.
53798621	413	607	25	53793221
53798620	613	407	25	53793220

Wood/synthetic		Shelf dimensions	
Art. No.	Width mm	Depth mm	Height mm
53798020	413	607	21
53798021	613	407	21

MEGAPROGRESS CABINET SHELF



Insert base with shelf carrier set for base, top-mounted and high cabinet, 580 mm deep		
Wood/synthetic		
Art. No.	Width mm	Depth mm
53798001	450	557
53798002	600	557
53798003	900	557
53798004	1200	557



Insert base with shelf carrier set for base, top-mounted and high cabinet, 580 mm deep, single-walled			
Powder-coated		Stainless steel	
Art. No.	Width mm	Depth mm	Art. No.
53798601	450	557	53793201
53798602	600	557	53793202
53798603	900	557	53793203
53798604	1200	557	53793204



Insert base with shelf carrier set for wall cabinet 300 mm deep		
Wood/synthetic		
Art. No.	Width mm	Depth mm
53798005	450	277
53798006	600	277
53798007	900	277
53798008	1200	277

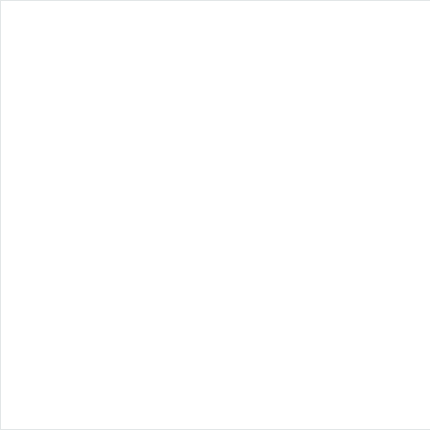

Insert base with shelf carrier set for wall cabinet 380 mm deep		
Wood/synthetic		
Art. No.	Width mm	Depth mm
53798009	450	357
53798010	600	357
53798011	900	357
53798012	1200	357

MEGAPROGRESS CABINET SHELF

Insert base with shelf carrier set

for wall cabinet, 300 mm deep, single-walled

Powder-coated			Stainless steel
Art. No.	Width mm	Depth mm	Art. No.
53798605	450	277	53793205
53798606	600	277	53793206
53798607	900	277	53793207
53798608	1200	277	53793208

Insert base with shelf carrier set

for wall cabinet, 380 mm deep, single-walled

Powder-coated			Stainless steel
Art. No.	Width mm	Depth mm	Art. No.
53798609	450	357	53793209
53798610	600	357	53793210
53798611	900	357	53793211
53798612	1200	357	53793212

Insert base with shelf carrier set

for base, top-mounted and high cabinet, 580 mm deep, double-walled

Powder-coated			Stainless steel
Art. No.	Width mm	Depth mm	Art. No.
53798701	450	557	53798501
53798702	600	557	53798502
53798703	900	557	53798503
53798704	1200	557	53798504

MEGAPROGRESS CABINET SHELF

Insert base with shelf carrier set

for wall cabinet, 300 mm deep, double-walled

Powder-coated			Stainless steel
Art. No.	Width mm	Depth mm	Art. No.
53798705	450	277	53798505
53798706	600	277	53798506
53798707	900	277	53798507
53798708	1200	277	53798508

Insert base with shelf carrier set

for wall cabinet, 380 mm deep, double-walled

Powder-coated			Stainless steel
Art. No.	Width mm	Depth mm	Art. No.
53798709	450	357	53798509
53798710	600	357	53798510
53798711	900	357	53798511
53798712	1200	357	53798512

Insert base with shelf carrier set

for wall cabinet 300 mm deep

Glass			
Art. No.	Width mm	Depth mm	Description
53798301	450	277	for wall cabinet 300 mm deep
53798302	600	277	for wall cabinet 300 mm deep
53798303	900	277	for wall cabinet 300 mm deep
53798304	1200	277	for wall cabinet 300 mm deep

Insert base with shelf carrier set

for wall cabinet 380 mm deep

Glass			
Art. No.	Width mm	Depth mm	Description
53798305	450	357	for wall cabinet 380 mm deep
53798306	600	357	for wall cabinet 380 mm deep
53798307	900	357	for wall cabinet 380 mm deep
53798308	1200	357	for wall cabinet 380 mm deep

MEGAPROGRESS SHELF

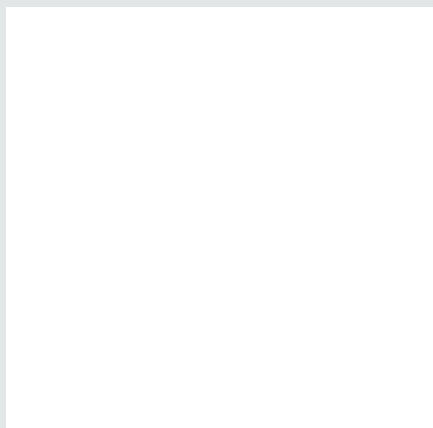

Insert base with shelf carrier set

for practice cabinet, 480 mm deep, double-walled

Glass

Art. No.	Width mm	Depth mm	Description
53798309	600	457	for practice cabinet, 480 mm deep
53798310	1200	457	for practice cabinet, 480 mm deep

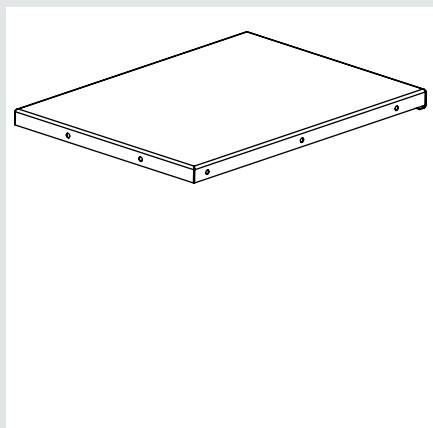

Cabinet shelf securely screwed on

for 600 mm wide cabinet incl. mounting

Powder-coated

Art. No.	Description
343466	single-walled
601351	reinforced

Stainless steel

Art. No.
601347
601352



Waste collector, round

for installation in base cabinet

Bin: stainless steel

Ring and insert: synthetic

Lid: synthetic

Stainless steel

Art. No.	Volume
602153	11 litres

MEGAPROGRESS LIGHT PANELS AND ACCESSORIES

Thebo lamp

with glare protection

White			St. steel appear.
Art. No.	Width mm	Description	Art. No.
604501	321	Underframe lightning, Model R3200, 8 W	604505
604502	470	Underframe lightning, Model R3200, 15 W	604506
604509	625	Underframe lightning, Model R3200, 18 W	604510
604503	753	Underframe lightning, Model R3200, 16 W	604507
604504	927	Underframe lightning, Model R3200, 30 W	604508

Locking socket

white, for Thebo lamp

Art. No.	Description
601497	Locking socket
601947	Plug for locking socket

Connection unit

for Thebo lamp, 100 mm long

Art. No.	Description
601501	White
601502	Stainless-steel appearance

Connection unit with switch

for Thebo lamp, 130 mm long

Art. No.	Description
604511	White
604512	Stainless-steel appearance

Connection cable for plug coupling

for Thebo lamp

Art. No.	Description
601498	Plug coupling cable 200 mm
601499	Plug coupling cable 500 mm
601500	Plug coupling cable 2000 mm

MEGAPROGRESS LIGHT PANELS AND ACCESSORIES

Light panels without lighting

Powder-coated			Stainless steel
Art. No.	Height mm	Description	Art. No.
54311001	100	straight (first running metre) max. width per panel 2000 mm	54311011
54311002	100	straight (each further metre) up to max. width per panel 1000 mm	54311012
54311003	100	L-shaped (first running metre) max. width per panel 2000 m	54311013
54311004	100	L-shaped (each further metre) up to max. width per panel 1000 mm	54311014
54311005	100	U-shaped (first running metre) max. width per panel 1700 mm	54311015
54311006	100	U-shaped (each further metre) up to max. width per panel 1000 mm	54311016

Integrated LED underframe lightning for retrofitting

LED underframe lightning in wall cabinet, with outside cabinet floor, incl. transformer and switch

Powder-coated		Stainless steel
Art. No.	for cabinet width mm	Art. No.
54351711	450/460	54351715
54351712	600/660	54351716
54351713	900/920	54351717
54351714	1200/1320	54351718

Integrated LED underframe lightning for retrofitting

LED underframe lightning in wall cabinet, with outside cabinet floor, without transformer and switch

Powder-coated		Stainless steel
Art. No.	for cabinet width mm	Art. No.
54351719	450/460	54351715
54351720	600/660	54351716
54351721	900/920	54351717
54351722	1200/1320	54351718

MEGAPROGRESS LED LIGHT PANELS AND ACCESSORIES

Integrated LED underframe lightning

LED underframe lightning integrated in wall cabinet

incl. transf. and switch	Description	without transf. and switch
Art. No.	for cabinet width mm	Art. No.
54351701	450/460	54351705
54351702	600/660	54351706
54351703	900/920	54351707
54351704	1200/1320	54351708



LED interior lighting

integrated in wall cabinet, base cabinet or high cabinet

single-/double-hinged without dividing wall	Description		double-hinged with dividing wall
Art. No.	for cabinet height mm	Height mm	Art. No.
54351701	Wall cabinet 600 mm	600	54351705
54351702	Base cabinet 750 mm	750	54351706
54351703	High cabinet 2000 mm	2000	54351707

LED interior lighting

for drawer cabinet

Art. No.	Description	for drawer width mm	Width mm
54350101	first drawer (contains the power supply for each additional drawer)	600	600
54350111	Each additional drawer	600	600
54350102	first drawer (contains the power supply for each additional drawer)	900	900
54350112	Each additional drawer	900	900
54350103	first drawer (contains the power supply for each additional drawer)	1200	1200
54350113	Each additional drawer	1200	1200

MEGAPROGRESS ELECTRONIC LOCK AND ACCESSORIES

LS 200 electronic lock

PIN code furniture locking system with capacitive keypad, round rotary knob, standard deadbolt, for right and left-hand doors, incl. mounting materials and battery pack, with RFID programming and RFID MasterCode radio

Art. No.	Description
54350301	Installation direction A, vertical rotary knob at top
54350302	Installation direction B, vertical rotary knob at bottom
54350303	Installation direction C, horizontal rotary knob on left
54350304	Installation direction D, horizontal rotary knob on right

LS 300 electronic lock

RFID furniture locking system with contactless alarm sensor, round rotary knob, standard deadbolt, for right and left-hand doors, incl. mounting materials and battery pack

Art. No.	Description
54350401	Installation direction A, vertical rotary knob at top
54350402	Installation direction B, vertical rotary knob at bottom
54350403	Installation direction C, horizontal rotary knob on left
54350404	Installation direction D, horizontal rotary knob on right

LS 400 electronic lock

PIN code/RFID furniture locking system with combined PIN code and RFID technology, with contactless alarm sensor, round rotary knob, standard deadbolt, for right and left-hand doors, incl. mounting materials and battery pack

Art. No.	Description
54350503	Installation direction C, horizontal rotary knob on left
54350504	Installation direction D, horizontal rotary knob on right

Accessories for electronic lock

Art. No.	Description	
543511	Battery pack	for LS 200, 300, 400
543506	SystemKey set	for programming and managing a locking system, RFID cards in ISO format
543507	USB table-top reader	for programming SystemKeys and other RFID data carriers
543508	Lock Manager 6, Version Key	Software for LS 200, 300, 400, for programming and managing locking systems with SystemKeys
543509	MIFARE 4k RFID cards, 20-piece pack	RFID data carriers as cards, unprinted, uncoded
543510	Training/instruction plus travel etc.	

MEGAPROGRESS MEGAClick, ACCESSORIES AND PARTITION WALL

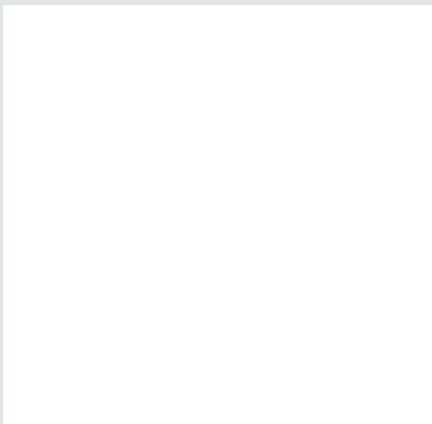
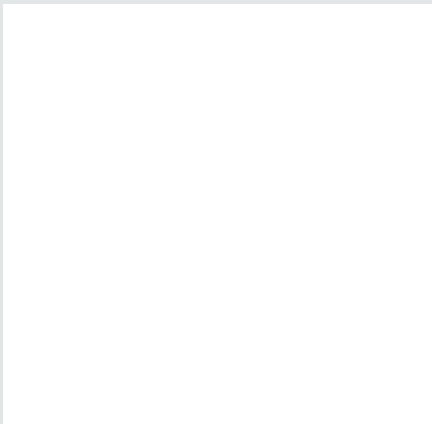
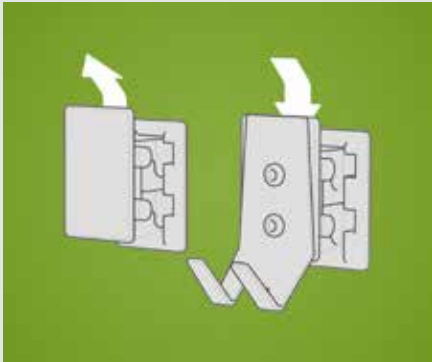

FF-click

without panel rear wall, etc., only MEGAClick in panels

Art. No.	
54351201	one row – 5 MEGAClick connectors
54351202	one row – 8 MEGAClick connectors
54351203	two row – 2 x 5 MEGAClick connectors
54351204	two row – 2 x 8 MEGAClick connectors

MP crystal clear marking sign

PU 10 pc

Art. No.	
543465	

Steel sheet centre partition wall

– When retrofitting double-door cabinets, a new left-hand cabinet door is required –

Art. No.	Description
602145	for high cabinet, 557/657 x 2000 mm, with slotted grid
602146	for base cabinet, 557/657 x 750 mm, with slotted grid
602147	for wall cabinet, 357 x 750 mm, with slotted grid

Stainless-steel centre partition wall

– When retrofitting double-door cabinets, a new left-hand cabinet door is required –

Art. No.	Description
602148	for high cabinet, 557/657 x 2000 mm, with slotted grid
602149	for base cabinet, 557/657 x 750 mm, with slotted grid
602150	for wall cabinet, 357 x 750 mm, with slotted grid

MEGAPROGRESS NARCOTICS SAFE

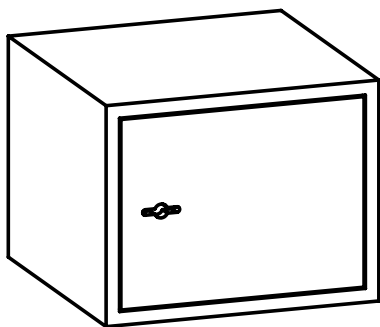

Opiate narcotics safe in accordance with VDMA 24992, Safety level A

Steel sheet, powder-coated

with grid rail, with cabinet shelf

Powder-coated

Art. No.	Width mm	Depth mm	Height mm	Description
246424	406	245	320	for wall cabinets Door hinging left
246425	406	245	320	for wall cabinets Door hinging right
246420	556	245	320	for wall cabinets Door hinging left
246421	556	245	320	for wall cabinets Door hinging right
246422	406	400	320	for high cabinets Door hinging left
246423	406	400	320	for high cabinets Door hinging right
246418	556	400	320	for high cabinets Door hinging left
246419	556	400	320	for high cabinets Door hinging right



Narcotics safe in accordance with EN 1143-1 Model 103-03

for high cabinets, with cabinet shelves

Powder-coated

Art. No.	Width mm	Depth mm	Height mm	Description
542944	500	410	340	Right-hand hinging, inside dimensions: 416 x 295 x 230 mm (W x D x H), weight: 95 kg
601364	500	410	340	Left-hand hinging, inside dimensions: 416 x 295 x 230 mm (W x D x H), weight: 95 kg

MEGAPROGRESS **NARCOTICS SAFE**



Narcotics safe in accordance with EN 1143-1 Model 103-01

for high cabinets, with cabinet shelves

Powder-coated

Art. No.	Width mm	Depth mm	Height mm	Description
601365	400	400	340	Left-hand hinging, inside dimensions: 316 x 270 x 230 mm (W x D x H), weight: 80 kg
542943	400	400	340	Right-hand hinging, inside dimensions: 316 x 270 x 230 mm (W x D x H), weight: 80 kg

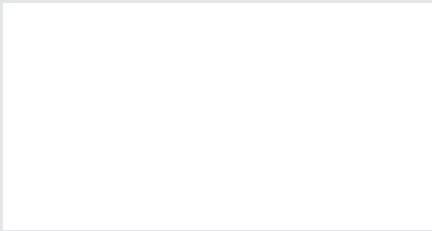

Spare key for narcotics safe according to sample

Art. No.	Description
601791	for narcotics safes in accordance with EN 1143-1



Spare key for narcotics safe

Art. No.	Description
601336	for narcotics key with key no.

MEGAPROGRESS ACCESSORIES

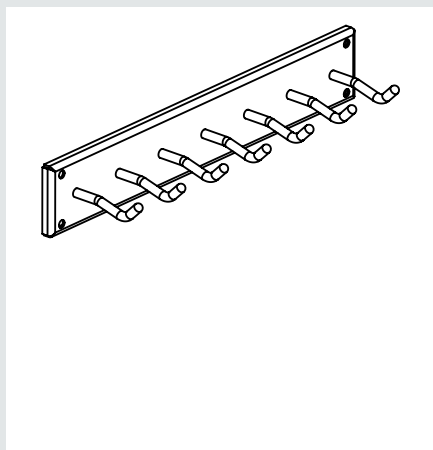

Hook rail for inside of door

in conjunction with shortened shelves

Stainless steel

Art. No.	Width mm
242055	300
242056	450

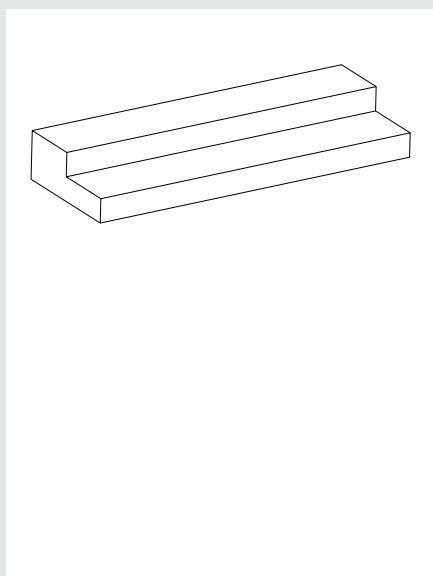

Stepped drug shelf for high cabinets – two-step

Powder-coated

Art. No.	For cabinet width mm	Depth mm	Height mm
53799301	450	160	80
53799302	600	160	80
53799303	900	160	80
53799304	1200	160	80

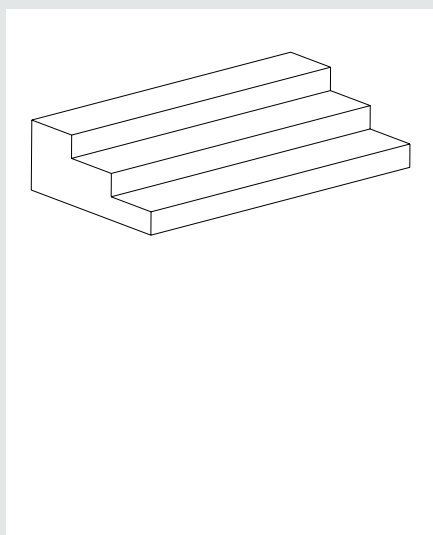

Stepped drug shelf for high cabinets – three-step

Powder-coated

Art. No.	For cabinet width mm	Depth mm	Height mm
53809901	450	300	120
53809902	600	300	120
53809903	900	300	120
53809904	1200	300	120

MEGAPROGRESS ACCESSORIES

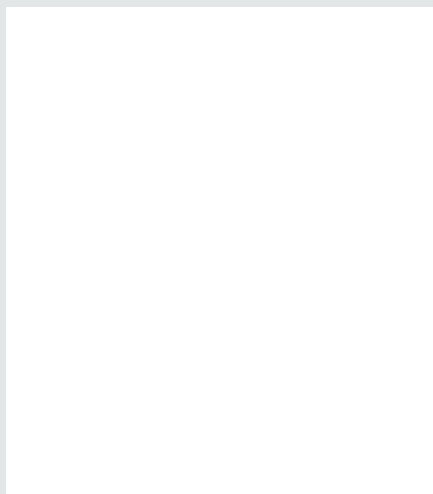

File rack

Art. No.	Width mm	Description
344204	450	Mounting of a file rack in a pull-out, 450 mm wide, complete frame
344273	450	Mounting of a file rack in a pull-out, 450 mm wide above lateral
344276	450	Mounting of a file rack in a pull-out, 450 mm wide above lateral



Angled support

stackable, synthetic, black
required quantity depends on drawer height

Art. No.	Width mm	Depth mm	Height mm
543019	328	212	35



Door limiter incl. mounting

Art. No.	Description
345565	for high cabinet/wall cabinet
345567	for base cabinet

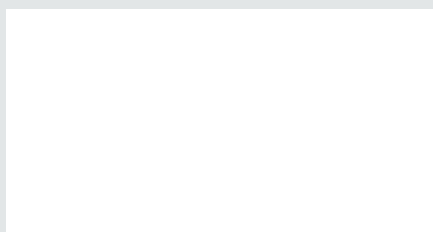

Clothes rod

mounted for high cabinet, consisting of oval clothes rod, chrome-plated with 2 mounts

Art. No.
602163

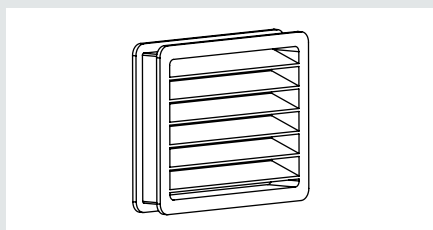

Ventilation grate for cabinet door

synthetic

Art. No.
247098

MEGAPROGRESS ACCESSORIES

Telescopic pull-out with angled mount, screwed on

Art. No.	Description
543020	Full extension, installation length 500 mm, pair
543021	Full extension, installation length 600 mm, pair

Desk utensil insert

with 8 compartments for use in pull-out worktop

Art. No.	Width mm	Depth mm	Height mm
145654	277	277	6

Interior drawer

Powder-coated

Art. No.

Width
mm

Height
mm

54324201

600

150

54324202

900

150

54324203

1200

150

Stainless steel

Art. No.

54342201

54342202

54342203

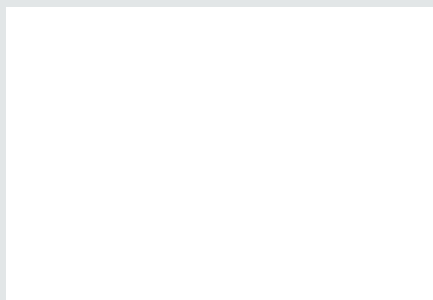
MEGAPROGRESS **ACCESSORIES****Pull-out worktop below a cabinet shelf**

for cabinet depth of 580 mm (dimensions = exterior dimensions incl. holder)

Duropol

Art. No.	Width mm	Depth mm	Height mm
537958	511	512	16

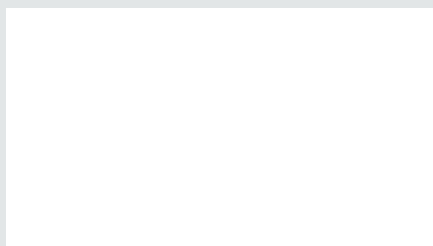
**Espagnolette lock for high cabinet**

Art. No.	Description
340562	Key actuation
340563	with rotary knob

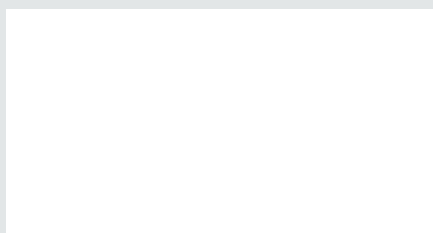
**Lever lock for base or wall cabinet door or individual drawer**

Art. No.
340564

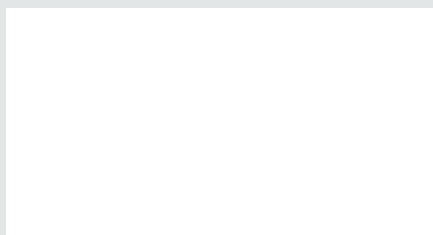
**Central locking for chest of drawers with up to 5 drawers**

for model MLT, not suitable for ISO underframes

Art. No.
542023

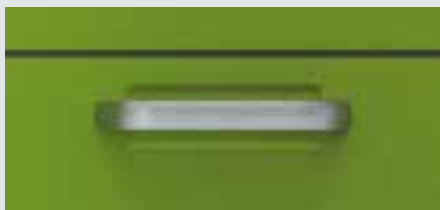
**FF MED U-handle**

Art. No.
607045

MEGAPROGRESS REFRIGERATION UNITS



Refrigerator

KUw 1544 Premium

Finish-compatible base cabinet refrigerator Liebherr KUw 1544,
Gross/usable content 137/132 l

3-star freezer compartment with ice cube tray, automatic defroster in refrigeration section, "glass-line" placement shelves (1 of which can be separated), "glass-line" shelves, butter/cheese compartment, butter box, bottle/can holder, energy consumption: in 365 days 237.5 kWh, energy efficiency class A, niche dimensions in cm: 820 x 600 x 570 mm (H x W x D)

Art. No.	Description
145499	left-hand door hinging
145500	right-hand door hinging



EK 16-20 refrigerator

Finish-compatible EK 1614-20 built-in refrigerator - gross/usable content 127/121 ltr.

3-star freezer compartment with ice cube tray, energy consumption: in 365 days 193.4 kWh, energy efficiency class A+, niche dimensions in cm: 874–878 x 560–570 x min. 550 mm (H x W X D)

Art. No.

146099



MED-85 drug refrigerator

Kirsch MED-85 drug refrigerator for built-in and under-surface mounting

Cooling capacity 80 ltr.

Normal consumption 0.6 kWh/24 h

Exterior dimensions (incl. wall spacing) 470 x 510 x 740 mm (W x D x H)

Art. No.

145710

MEGAPROGRESS REFRIGERATION UNITS



MED-100 drug refrigerator

Kirsch MED-100 drug refrigerator for built-in and under-surface mounting
Door hinging right/left (can be changed)
Exterior dimensions 540 x 530 x 820 mm (W x D x H)

Art. No.

247348



MED125 drug refrigerator

Kirsch MED-125 drug refrigerator for built-in and under-surface mounting
Cooling capacity 120 ltr.
Normal consumption 0.55 kWh/24 h
Exterior dimensions (incl. wall spacing) 540 x 535 x 810 mm (W x D x H)

Art. No.	Width mm	Depth mm	Height mm	Description
600933	540	535	810	left-hand door hinging
600934	540	535	810	right-hand door hinging



FROSTER-MED-70 freezer

Kirsch FROSTER-MED-70 freezer for built-in and under-surface mounting
Cooling capacity 70 ltr.
Normal consumption 1.6 kWh/24 h
Exterior dimensions without table top 470 x 510 x 740 mm (W x D x H)

Art. No.

245910

MEGAPROGRESS REFRIGERATION UNITS



FROSTER-MED-95 freezer

Kirsch FROSTER-MED-95 freezer for built-in and under-surface mounting
Cooling capacity 95 ltr.

Normal consumption 2.8 kWh/24 h

Exterior dimensions without table top 540 x 530 x 820 mm (W x D x H)

Art. No.

247349



BL-100 stored blood refrigerator

Kirsch BL-100 stored blood refrigerator for built-in and under-surface mounting
Cooling capacity 95 ltr.

Normal consumption 0.35 kWh/24 h

Exterior dimensions without table top 540 x 530 x 820 mm (W x D x H)

Art. No.

245911

MEGAPROGRESS PANELS AS PER DIN AND ISO STANDARD, POWDER-COATED

Panels for cabinets as per DIN and ISO standard, powder-coated

Powder-coated			
Art. No.	Width mm	Height mm	Description
54056901	450/460	up to 200	Ceiling panel with fastening materials, low
54056902	600/660	up to 200	Ceiling panel with mounting materials, low
54056903	900/920	up to 200	Ceiling panel with mounting materials, low
54056904	1200/1320	up to 200	Ceiling panel with mounting materials, low
54057901	450/460	up to 200	Ceiling panel, closed at bottom, with mounting materials
54057902	600/660	up to 200	Ceiling panel, closed at bottom, with mounting materials
54057903	900/920	up to 200	Ceiling panel, closed at bottom, with mounting materials
54057904	1200/1320	up to 200	Ceiling panel, closed at bottom, with mounting materials
54057001	450/460	200-900	Ceiling panel with mounting materials, high
54057002	600/660	200-900	Ceiling panel with mounting materials, high
54057003	900/920	200-900	Ceiling panel with mounting materials, high
54057004	1200/1320	200-900	Ceiling panel with mounting materials, high
54342901	450/460	up to 1050 mm	Ceiling panel with mounting materials, can be cut to size
54342902	600/660	up to 1050 mm	Ceiling panel with mounting materials, can be cut to size
54342903	900/920	up to 1050 mm	Ceiling panel with mounting materials, can be cut to size
54342904	1200/1320	up to 1050 mm	Ceiling panel with mounting materials, can be cut to size
54058001	450/460	200-900	Ceiling panel, closed at bottom, with mounting materials
54058002	600/660	200-900	Ceiling panel, closed at bottom, with mounting materials
54058003	900/920	200-900	Ceiling panel, closed at bottom, with mounting materials
54058004	1200/1320	200-900	Ceiling panel, closed at bottom, with mounting materials
540825	up to 300	up to 2100	High cabinet side panel/side wall extension with plinth section
540582	up to 300	up to 2100	High cabinet side panel/side wall extension with top cover and plinth section
540827	up to 300	up to 2100	High cabinet intermediate panel with top cover and plinth section
540864	up to 300	up to 2100	High cabinet corner panel with plinth section without top cover
540828	up to 300	up to 2100	High cabinet corner panel with plinth section with top cover
540591		700-850	Base cabinet corner panel with plinth section, low
540585	up to 300	700-850	Base cabinet side panel/side wall extension with plinth section, low
540829	up to 300	700-850	Base cabinet intermediate panel with plinth section, low
540834	up to 300	600-750	Wall cabinet corner panel, closed at top and bottom, low
540587	up to 300	600-750	Wall cabinet side/intermediate panel, low
54086601		up to 750	Rear wall screen panel for base/top-mounted cabinet
54086602		up to 2000	Rear wall screen panel for high cabinet
54086901		up to 650	Rear wall (niche panel) between table top and wall cabinet, max. width 2600 mm
54086902		up to 650	Rear wall (niche panel) between table top and wall cabinet, powder-coated, max. width 2600 mm
543519		100	Plinth end piece

MEGAPROGRESS PANELS AS PER DIN AND ISO STANDARD, STAINLESS STEEL

Panels for cabinets as per DIN and ISO standard, stainless steel

Stainless steel			
Art. No.	Width mm	Height mm	Description
53056901	450/460	up to 200	Ceiling panel with mounting materials, low
53056902	600/660	up to 200	Ceiling panel with mounting materials, low
53056903	900/920	up to 200	Ceiling panel with mounting materials, low
53056904	1200	up to 200	Ceiling panel with mounting materials, low
53057901	450/460	up to 200	Ceiling panel, closed at bottom, with mounting materials
53057902	600/660	up to 200	Ceiling panel, closed at bottom, with mounting materials
53057903	900/920	up to 200	Ceiling panel, closed at bottom, with mounting materials
53057904	1200	up to 200	Ceiling panel, closed at bottom, with mounting materials
53057001	450/460	200-900	Ceiling panel with mounting materials, high
53057002	600/660	200-900	Ceiling panel with mounting materials, high
53057003	900/920	200-900	Ceiling panel with mounting materials, high
53057004	1200	200-900	Ceiling panel with mounting materials, high
54353001	450/460	up to 1050 mm	Ceiling panel with mounting materials, can be cut to size
54353002	600/660	up to 1050 mm	Ceiling panel with mounting materials, can be cut to size
54353003	900/920	up to 1050 mm	Ceiling panel with mounting materials, can be cut to size
54353004	1200	up to 1050 mm	Ceiling panel with mounting materials, can be cut to size
53058001	450/460	200-900	Ceiling panel, closed at bottom, with mounting materials
53058002	600/660	200-900	Ceiling panel, closed at bottom, with mounting materials
53058003	900/920	200-900	Ceiling panel, closed at bottom, with mounting materials
53058004	1200	200-900	Ceiling panel, closed at bottom, with mounting materials
530825	up to 300	up to 2100	High cabinet side panel/side wall extension with plinth section
530582	up to 300	up to 2100	High cabinet side panel/side wall extension with top cover and plinth section
530827	up to 300	up to 2100	High cabinet intermediate panel with top cover and plinth section
530864	up to 300	up to 2100	High cabinet corner panel with plinth section without top cover
530828	up to 300	up to 2100	High cabinet corner panel with plinth section with top cover
530591		700-850	Base cabinet corner panel with plinth section, low
530585	up to 300	700-850	Base cabinet side panel/side wall extension with plinth section, low
530829	up to 300	700-850	Base cabinet intermediate panel with plinth section, low
530587	up to 300	600-750	Wall cabinet side/intermediate panel, low
530834	up to 300	600-750	Wall cabinet corner panel, closed at top and bottom, low
54086604		up to 750	Rear wall screen panel for base/top-mounted cabinet, max. width 1200 mm
54086605		up to 2000	Rear wall screen panel for high cabinet
53086901		up to 650	Rear wall (niche panel) between table top and wall cabinet, max. width 2600 mm
537939		100	Plinth end piece

MEGAPROGRESS LADDERS FOR CABINETS AS PER DIN AND ISO STANDARD



Ladder frame for high cabinet with top-mounted cabinet

Ladder frame as attachment for high cabinets, including slide rail

Powder-coated			Stainless steel
Art. No.	Height mm	Description	Art. No.
54321701	100	for hook-in ladder height 100 mm, max. width 2000 mm per frame, first running metre	54321801
54321702	100	for hook-in ladder, height 100 mm, max. width 2000 mm per frame, each further running metre	54321802
54321703	165	for rolling ladder, height 170 mm, max. width 2000 mm per frame, first running metre	54321803
54321704	165	for hook-in ladder, height 170 mm, max. width 2000 mm per frame, each further running metre	54321804

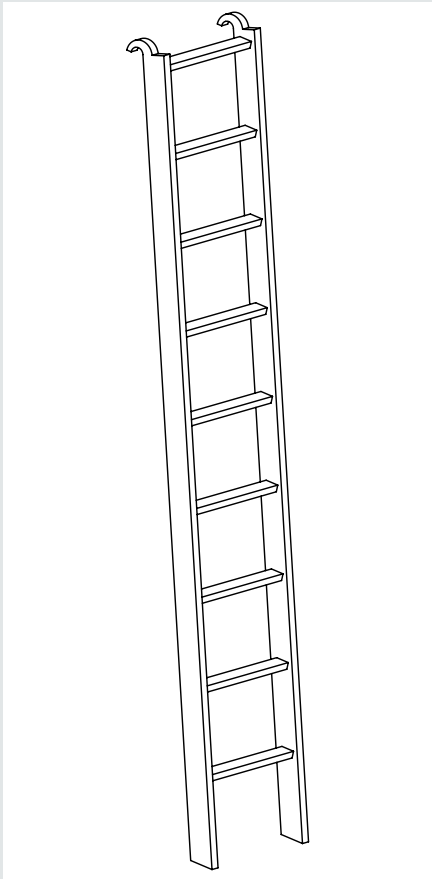

Ladders

Aluminium	
Art. No.	Description
145505	Hook-in ladder, ALU, height 2170 mm, 8 steps
145506	Rolling ladder, ALU, height 2170, 8 steps
543241	Parking position for hook-in ladder, pair

MEGAPROGRESS PANELS AS PER DIN AND ISO STANDARD

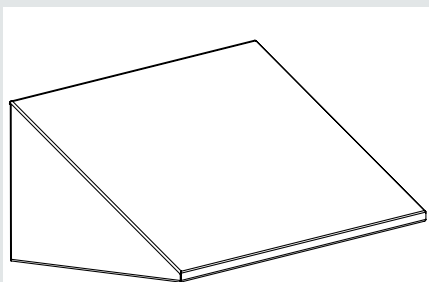

Angled top panels for cabinets as per DIN and ISO standard

25 mm at front, 235 mm at rear,
up to max. width 1960 mm, for powder-coated steel sheet, up to max. width 1320 mm for
stainless steel in depths: 300 mm, 380 mm, 480 mm, 580 mm, 680 mm

Powder-coated			St. steel
Art. No.	Depth (mm)		Art. No.
54323501	300/380	first running metre	54323701
54323511	300/380	each further running metre up to max. width	54323711
54323502	480/580	first running metre	54323702
54323512	480/580	each further running metre up to max. width	54323712
54323503	680	first running metre	54323703
54323513	680	each further running metre up to max. width	54323713

Cut-out in ceiling panels

Art. No.	Description
602165	Length up to 800 mm

Cut-out in cabinet rear wall including panel

Art. No.
602135

MEGAPROGRESS WALL SHELF

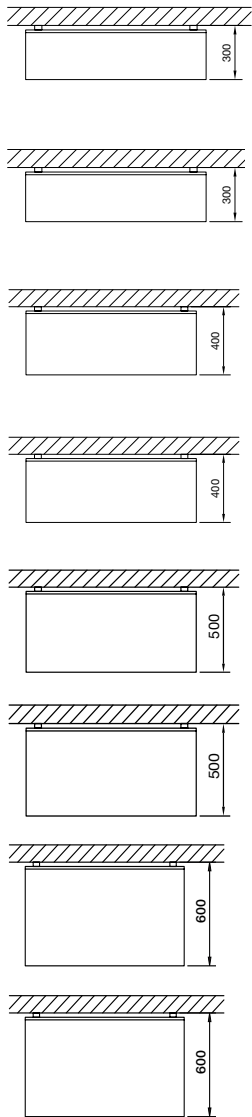

Wall shelf

MWR model

Max. width 2400 mm, surface 240 grain polished
Wall shelves, smooth. Turned down 30 mm on all sides
Load-bearing capacity with evenly distributed load 75 kg per running metre

Stainless steel

Art. No.	Depth mm	Description
53639901	300	single-walled, first running metre
53639911	300	single-walled, each further metre up to max. width
53640001	300	double-walled, first running metre
53640011	300	double-walled, each further metre up to max. width
53639902	400	single-walled, first running metre
53639912	400	single-walled, each further metre up to max. width
53640002	400	double-walled, first running metre
53640012	400	double-walled, each further metre up to max. width
53639903	500	single-walled, first running metre
53639913	500	single-walled, each further metre up to max. width
53640003	500	double-walled, first running metre
53640013	500	double-walled, each further metre up to max. width
53639904	600	single-walled, first running metre
53639914	600	single-walled, each further metre up to max. width
53640004	600	double-walled, first running metre
53640014	600	double-walled, each further metre up to max. width

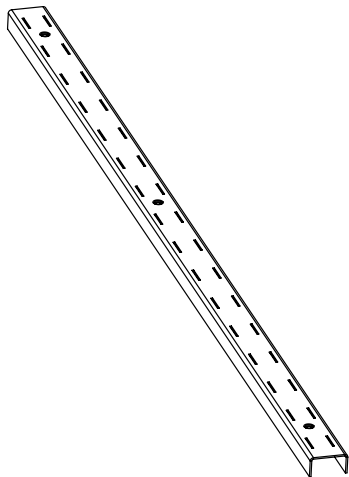

VS wall-mount rails

VS model

Stainless steel

Art. No.	Description
53699501	Model VS 0300
53699502	Model VS 0600
53699503	Model VS 0900
53699504	Model VS 1200
53699505	Model VS 1500
53699506	Model VS 1800
53699507	Model VS 2000

MEGAPROGRESS WALL SHELF

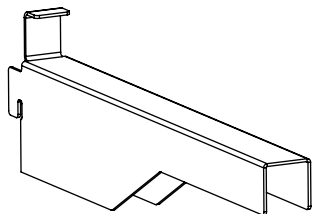

Brackets

KO-V model

for wall-mount rails, height-adjustable

Stainless steel

Art. No.	Depth mm	Description
53699601	300	Required number of brackets: Shelf length 1000 mm – 2 pieces Shelf length 1600 mm – 3 pieces Shelf length 2200 mm – 4 pieces
53699602	400	Required number of brackets: Shelf length 800 mm – 2 pieces Shelf length 1300 mm – 3 pieces Shelf length 1800 mm – 4 pieces Shelf length 2200 mm – 5 pieces
53699603	500	Required number of brackets: Shelf length 800 mm – 2 pieces Shelf length 1300 mm – 3 pieces Shelf length 1800 mm – 4 pieces Shelf length 2200 mm – 5 pieces
53699604	600	Required number of brackets: Shelf length 700 mm – 2 pieces Shelf length 1100 mm – 3 pieces Shelf length 1500 mm – 4 pieces Shelf length 1900 mm – 5 pieces Shelf length 2300 mm – 6 pieces

The FF Co. Ltd.

FF Fémfeldolgozó Co. Ltd. is a medium-sized, family-owned company in Hungary.

For decades we have been specialists in the processing of stainless steel and electrolytically galvanized steel. With our modern machine park, electropolishing facility and powder coating capabilities the main focus of our production program are products for professional commercial kitchens, complete systems for shop-baking equipment, accessories for sterilization equipment and our own "medical line" with furniture for clinics, ambulances and medical practices of the highest quality.

With highly qualified technical staff we are constantly working to improve our products and to implement individual customer requests.

Our head office is located in Budapest, the production site in Mezőtúr.

The product range consists of cabinet systems, functional trolleys, sterile services equipment and mobile furnishings for the operating room.

All of FF Co. Ltd. Professional's divisions have DIN EN ISO 9001:2015, 14001:2015 certification, guaranteeing a high standard of reliability and customer orientation.

Our Partner in

Germany and Western Europe:

MED-Systeme GmbH

<http://www.med-systeme.de>



All other countries:

FF Co. Ltd. Hungary

<http://ffzrt.hu>

